

FORT FLOOR PLAN
FORT PURCELL, TORTOLA
 CVE BOX 388 CORNING NY 14830 11/00

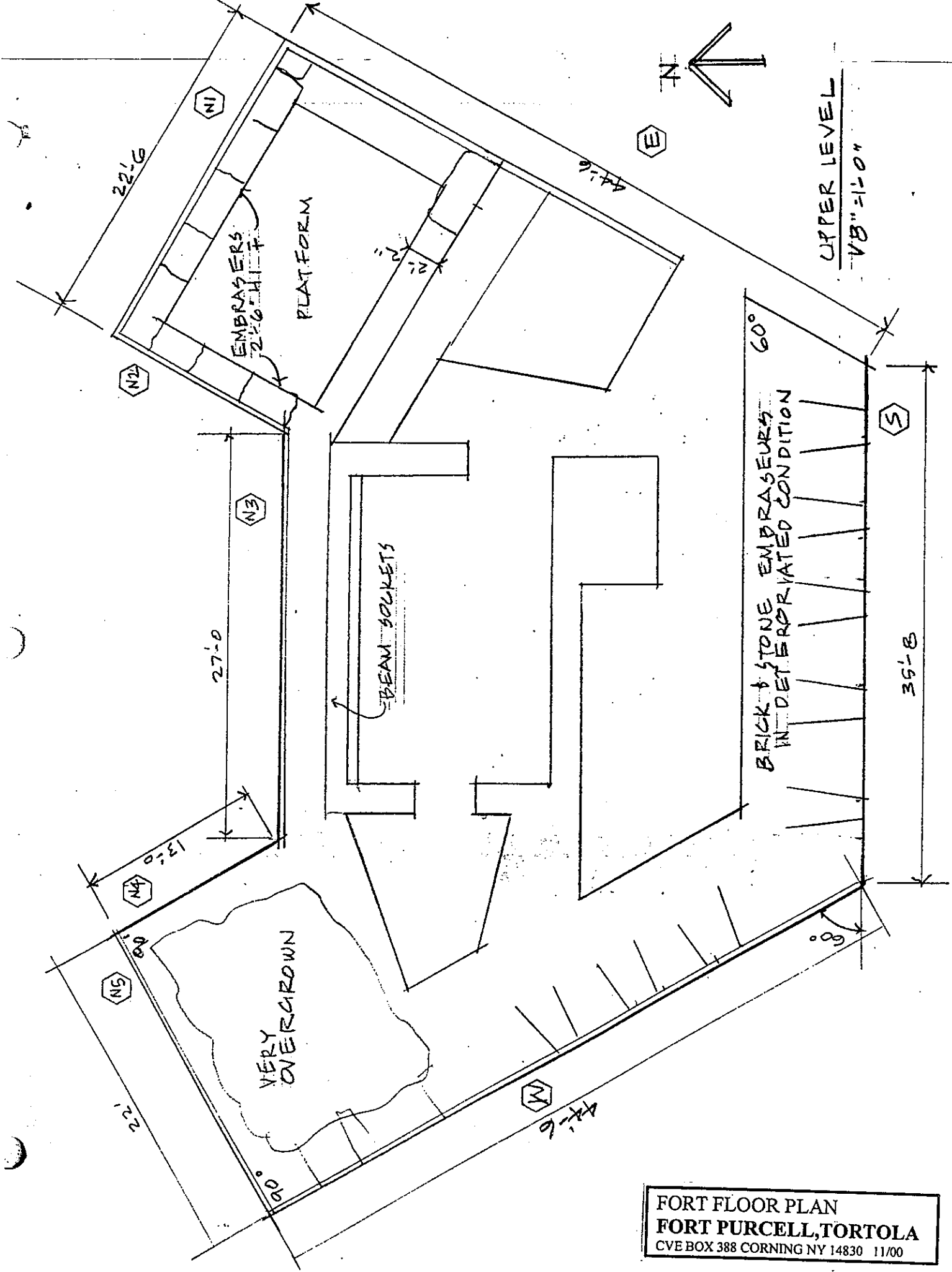

FORT FLOOR PLAN
FORT PURCELL, TORTOLA
 CVE BOX 388 CORNING NY 14830 11/00

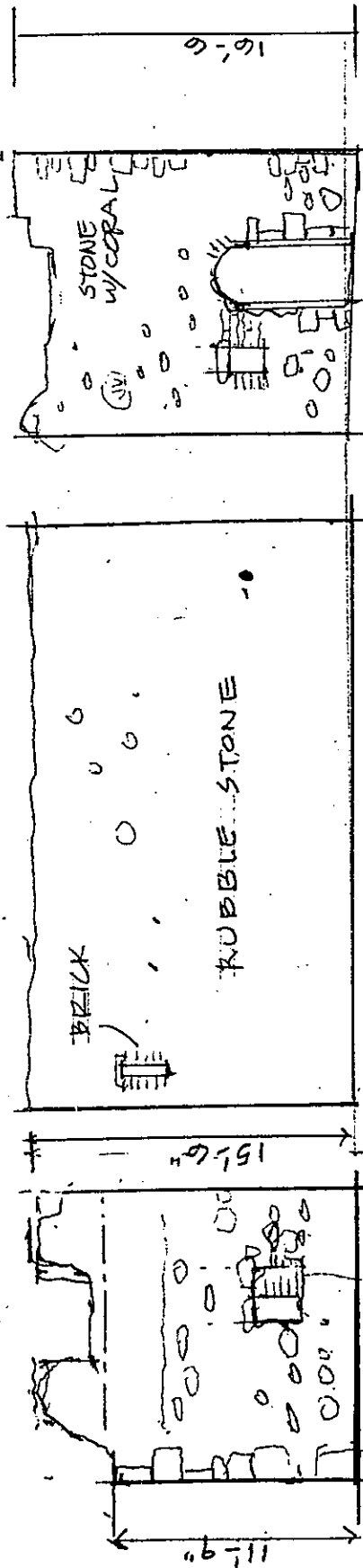

N4

N3

BRICK AT OPENINGS

N2

ELEVATIONS
18" = 1'-0"

BRICK
EMBRASERS

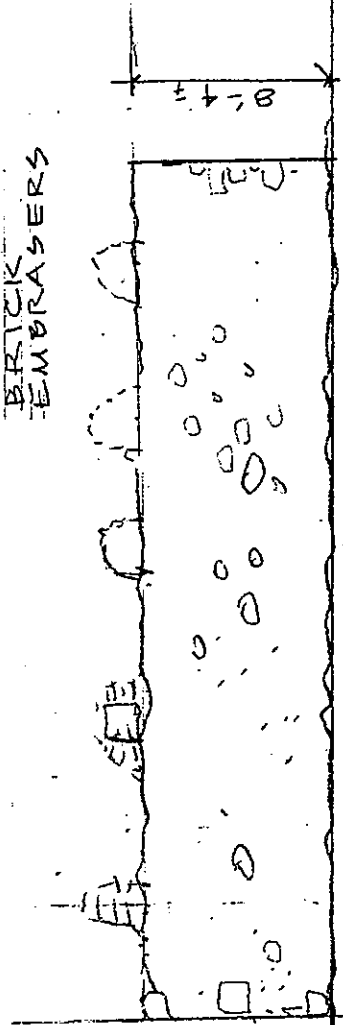

S

SOIL
10' = 1'-0"

ELEVATIONS
1/8" = 1'-0"

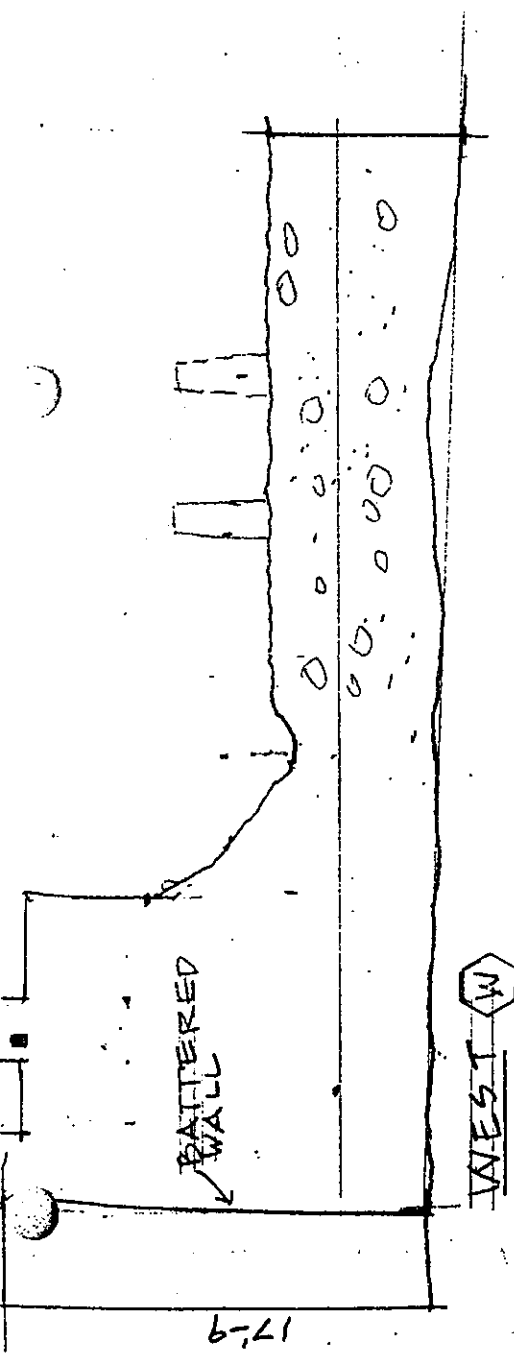

TYPICAL
LARGE CUT STONES
AT CORNERS

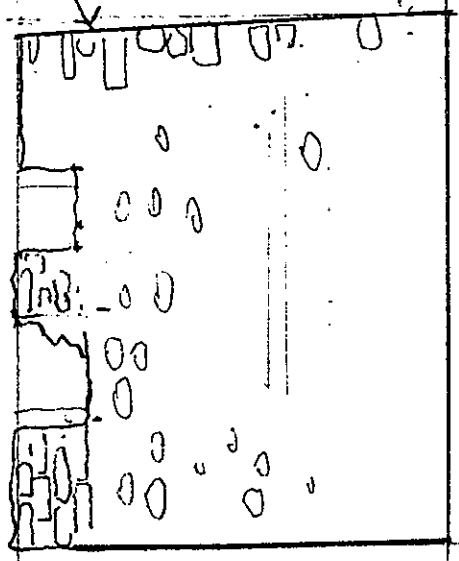

BRICK JAMB &
ARCH WITH
STONE KEYSTONE

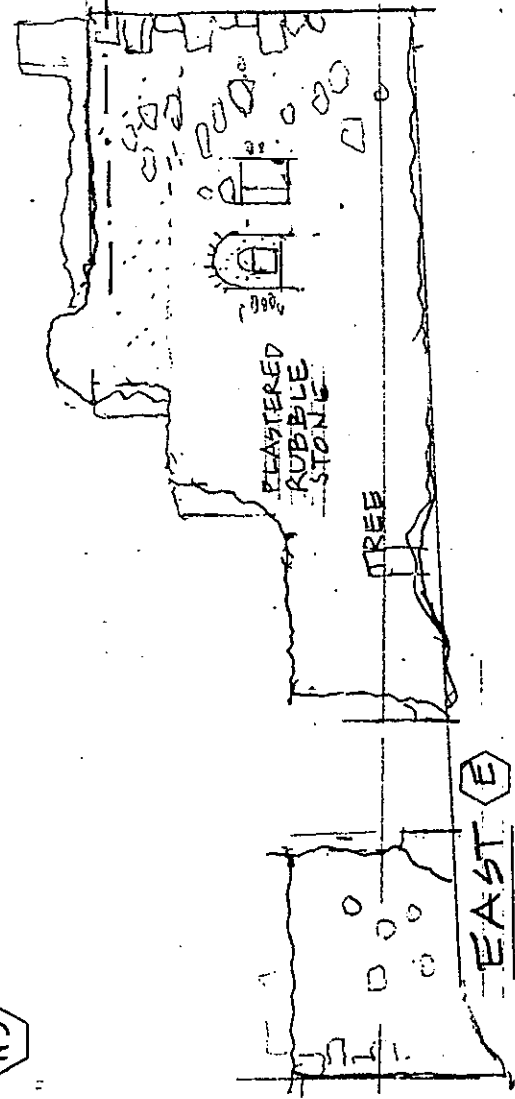
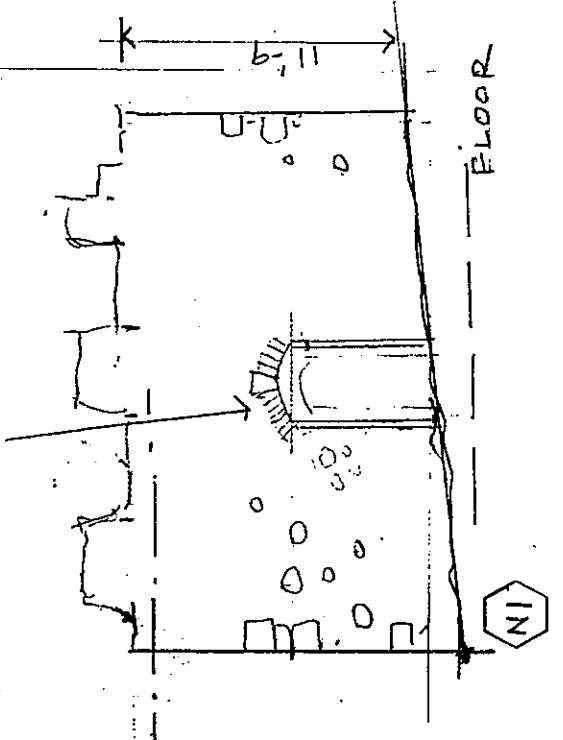

FORT ELEVATIONS
FORT PURCELL, TORTOLA
CVE BOX 388 CORNING NY 14830 11/00

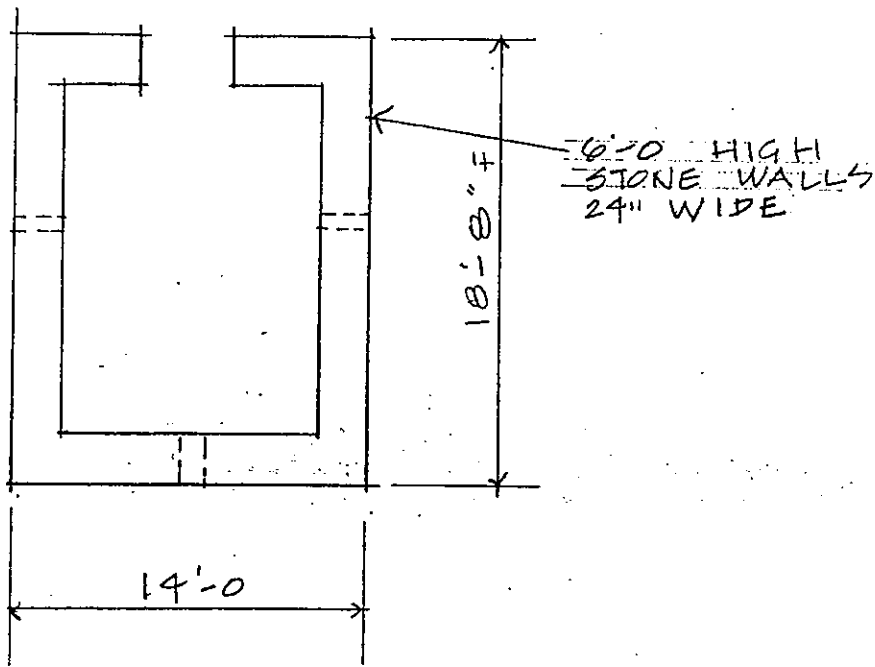

FLOOR PLAN

1/8" = 1'-0"



APPROX

SMALL BUILDING
FORT PURCELL, TORTOLA
CVE BOX 388 CORNING NY 14830 11/00

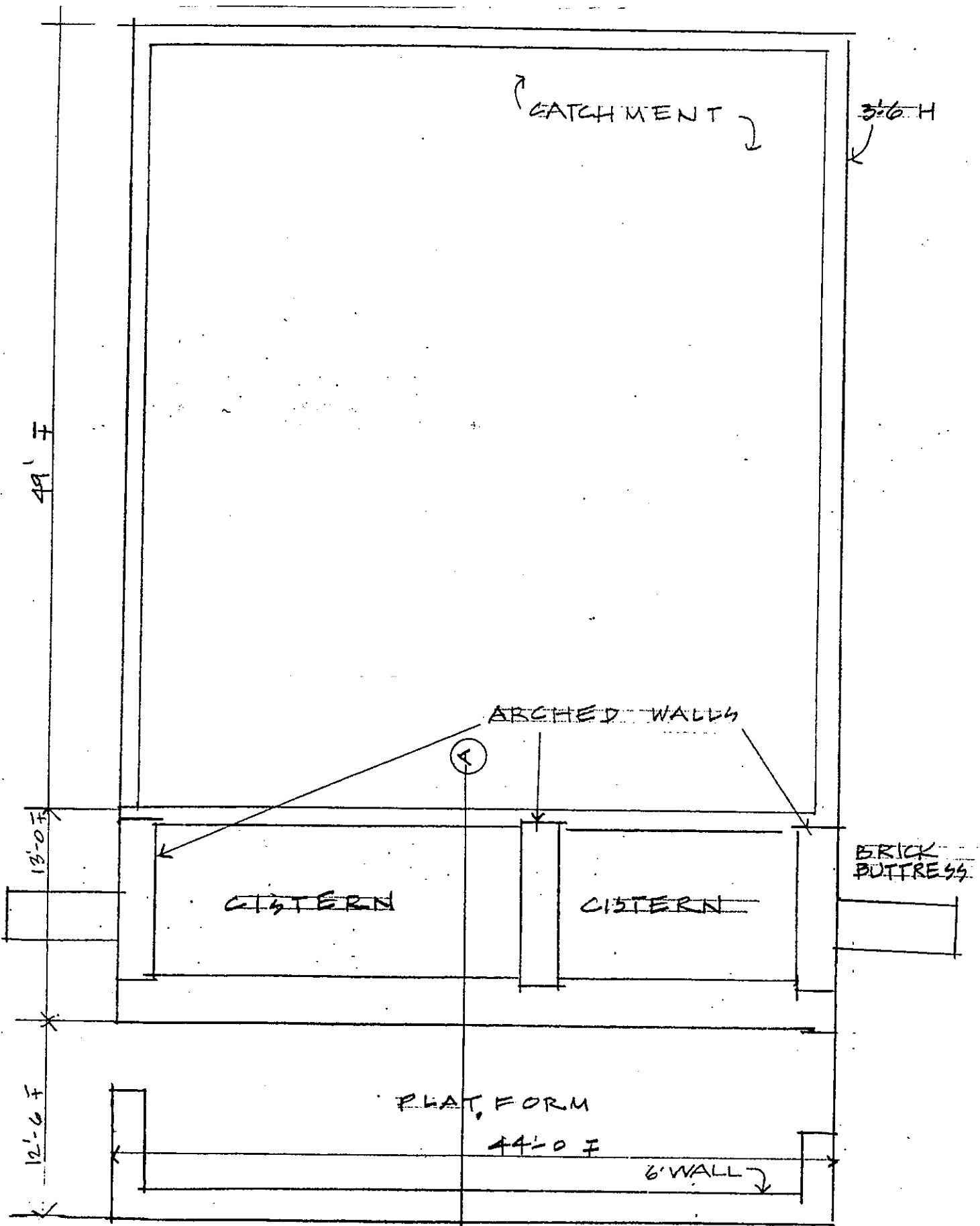

CISTERN AND CATCHMENT
FORT PURCELL, TORTOLA
 CVE BOX 388 CORNING NY 14830 11/00

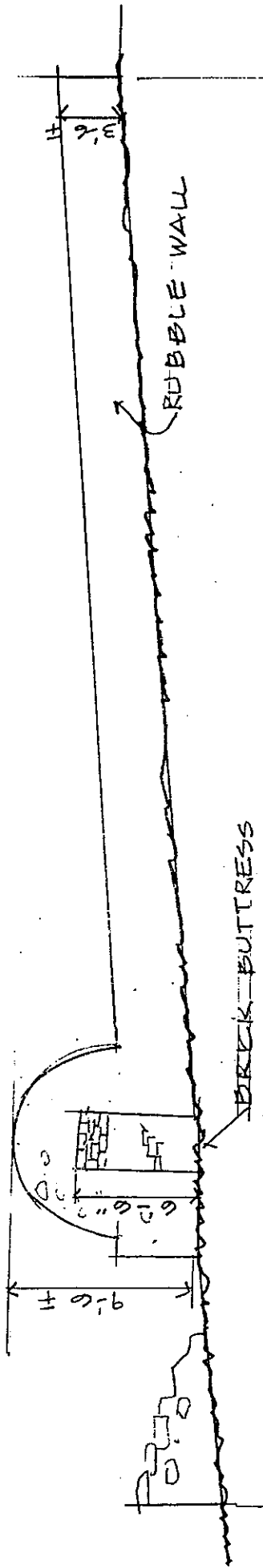

EAST ELEVATION
1/8" = 1'-0"

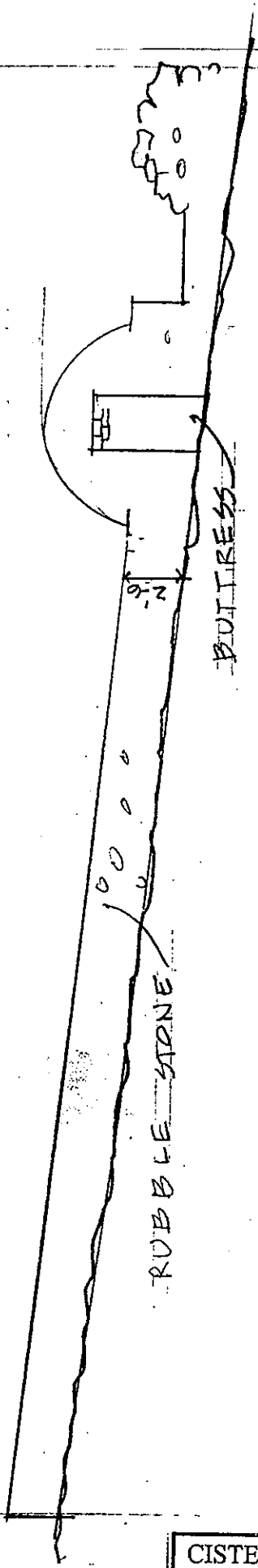

WEST ELEVATION
1/8" = 1'-0"

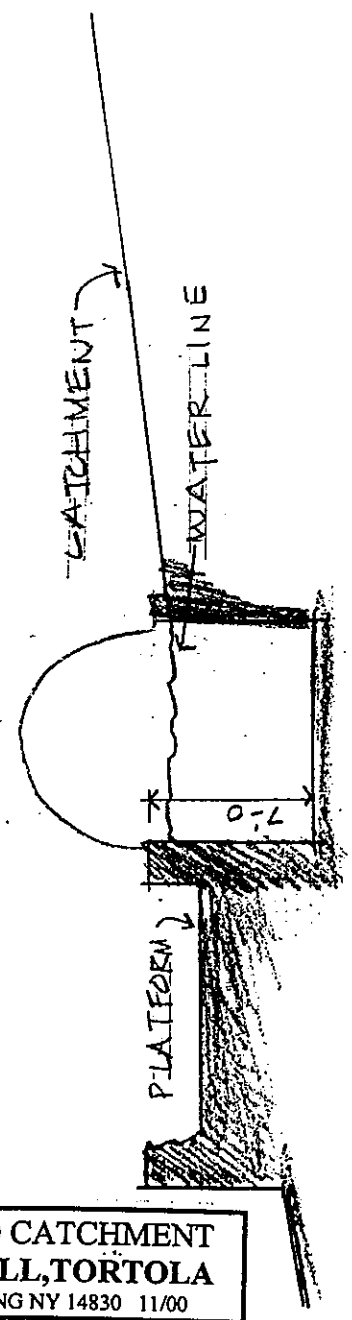

SECTION A
1/8"

CISTERN AND CATCHMENT
FORT PURCELL, TORTOLA
CVE BOX 388 CORNING NY 14830 11/00

MORE MAJOR WALLS
 PLATFORMS & STEPS
 IN THIS AREA -
 CLEARING REQUIRED
 FOR FURTHER DOCUMENTATION

MORE MAJOR
 WALLS & PLATFORMS
 CLEARING REQUIRED

LOCATION UNCERTAIN

14' x 18'
 BUILDING

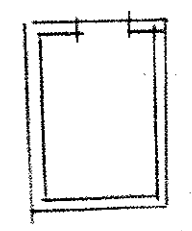

VERY
 OVERGROWN

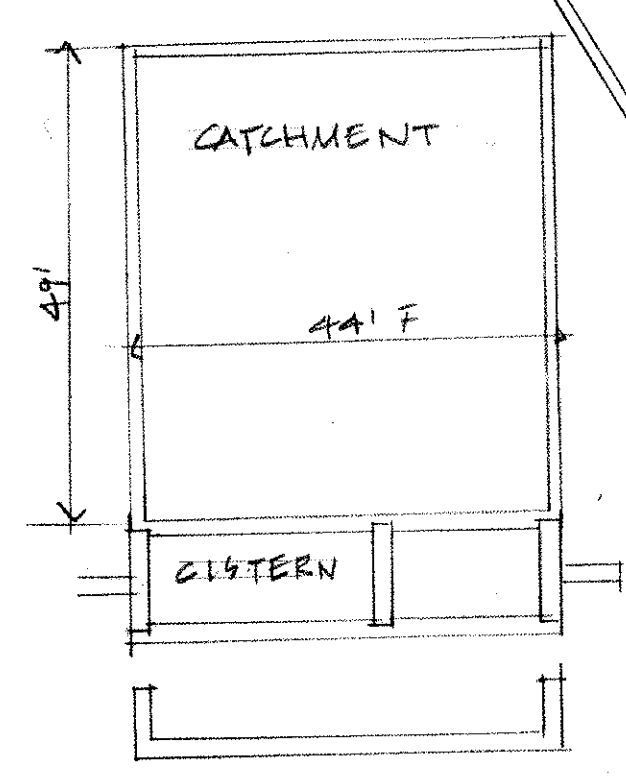
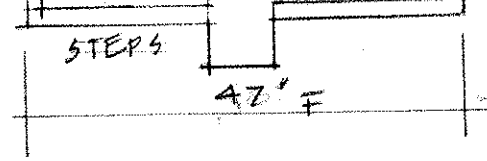

VERIFY LOCATIONS

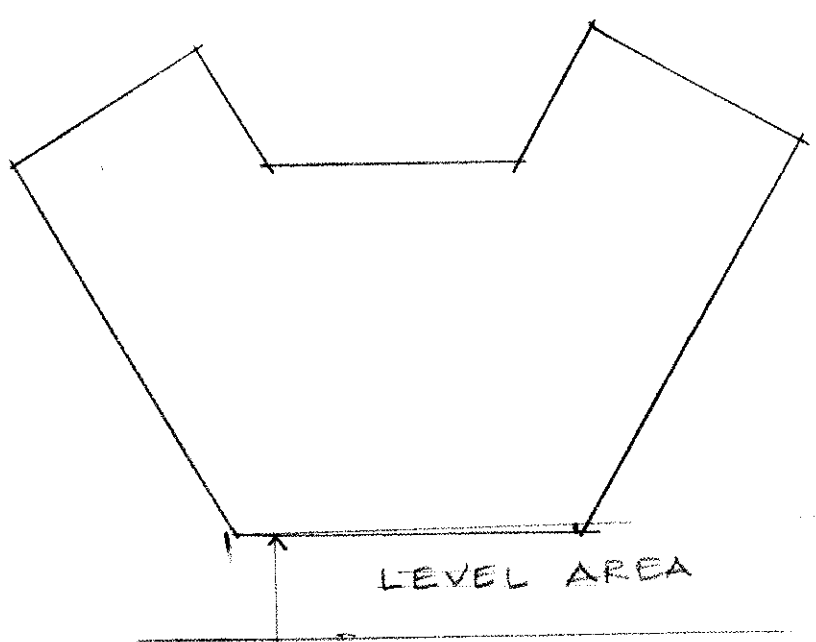

STEEP BANK

ROAD

APPROX 75'

SEA

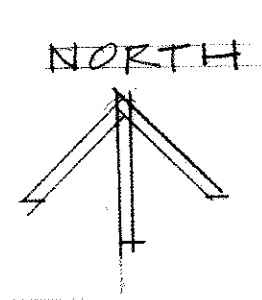

SITE DIAGRAM

1" = 20'

BECAUSE CONDITIONS WERE VERY OVERGROWN
 SIZES & RELATIONSHIPS ARE APPROXIMATE

BY
 CARIBBEAN VOLUNTEER EXPEDITIONS
 BOX 388 CORNING NY 14830 NOV 2000

FORT PURCELL TORTOLA BVI