

HOUSE NO. 1 - WEST ELEVATION

SCALE: 1/4" = 1'-0"

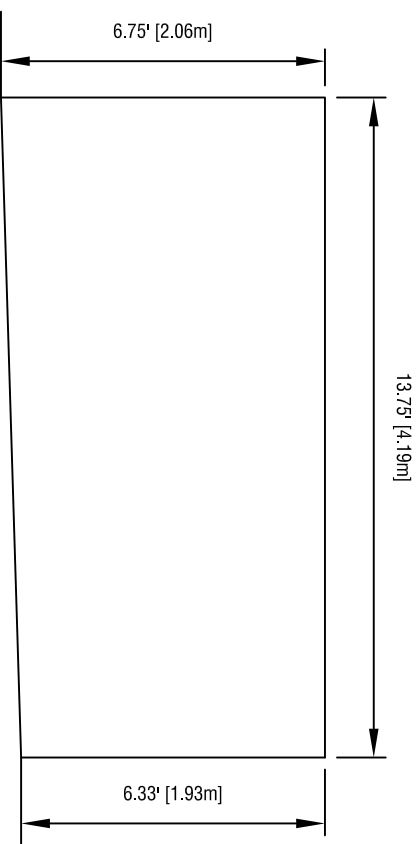

HOUSE NO. 1 - EAST ELEVATION

SCALE: 1/4" = 1'-0"

POLLY HILL SETTLEMENT

SAN SALVADOR, BAHAMAS, MARCH 2007

PREPARED BY: CARIBBEAN VOLUNTEER EXPEDITIONS (CVE)

VOLUNTEERS: FLORENCE BAKER, ROBERT GARBARK, BARBARA RICE,

SUSAN RICE, ROBERT TAYLOR

ALONG WITH DR. JOHN WINTER, JOHN COPICH, DON BERNIER AND MOLLOY  
COLLEGE STUDENTS - LEIF HAZLEWOOD AND JACI HEALY

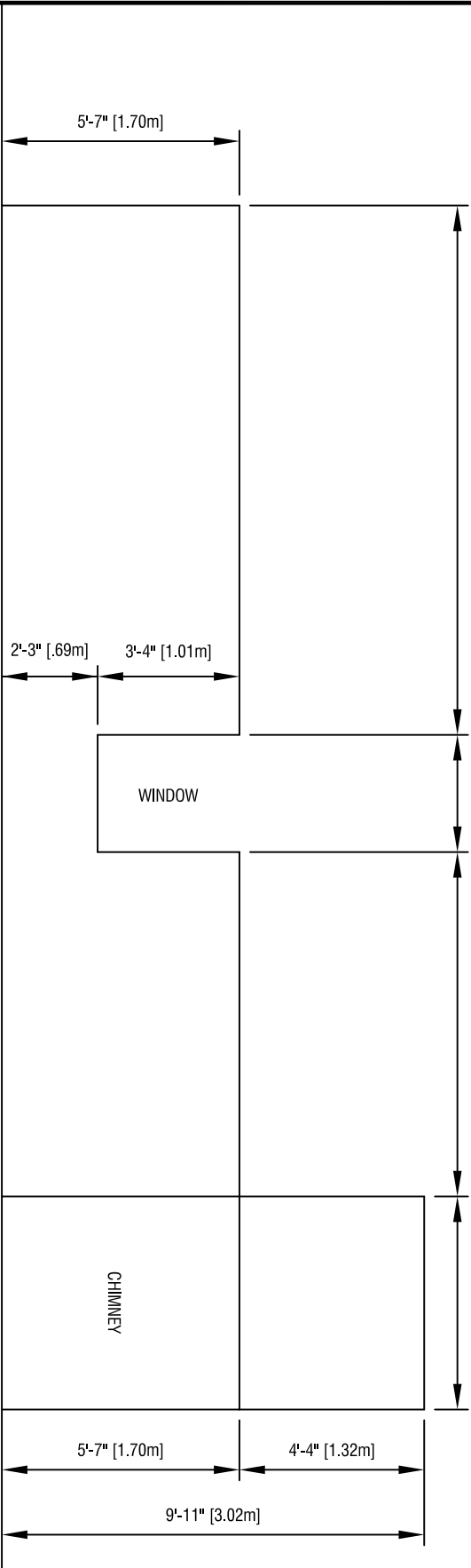

HOUSE NO. 1 - NORTH ELEVATION  
SCALE: 1/4" = 1'-0"

**POLLY HILL SETTLEMENT**  
SAN SALVADOR, BAHAMAS, MARCH 2007

**PREPARED BY: CARIBBEAN VOLUNTEER EXPEDITIONS (CVE)**  
VOLUNTEERS: FLORENCE BAKER, ROBERT GARBARK, BARBARA RICE,  
SUSAN RICE, ROBERT TAYLOR

ALONG WITH DR. JOHN WINTER, JOHN COPICH, DON BERNIER AND MOLLOY  
COLLEGE STUDENTS - LEIF HAZLEWOOD AND JACI HEALY

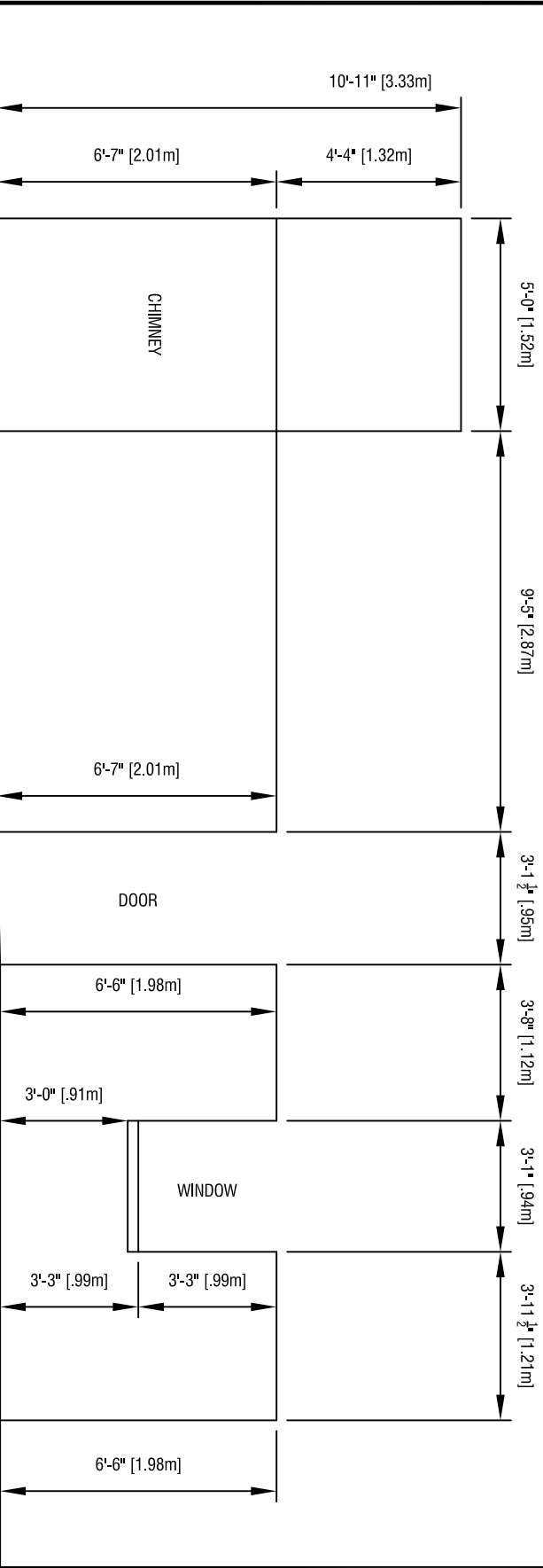

HOUSE NO. 1 - SOUTH ELEVATION  
SCALE: 1/4" = 1'-0"

POLLY HILL SETTLEMENT  
SAN SALVADOR, BAHAMAS, MARCH 2007

PREPARED BY: CARIBBEAN VOLUNTEER EXPEDITIONS (CVE)  
VOLUNTEERS: FLORENCE BAKER, ROBERT GARBARK, BARBARA RICE,  
SUSAN RICE, ROBERT TAYLOR

ALONG WITH DR. JOHN WINTER, JOHN COPICH, DON BERNIER AND MOLLOY  
COLLEGE STUDENTS - LEIF HAZLEWOOD AND JACI HEALY

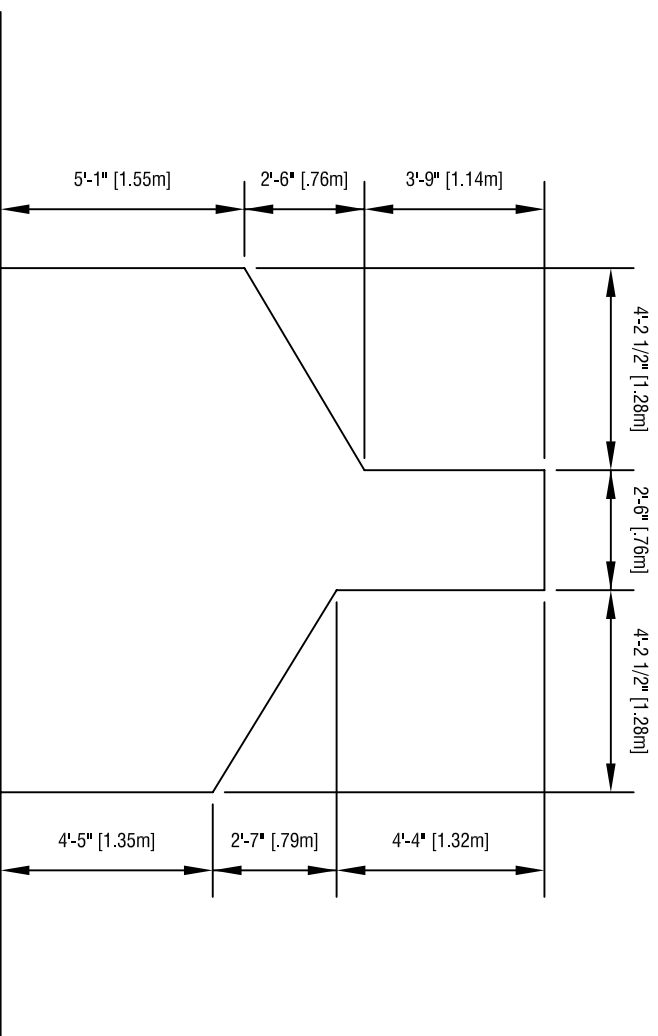

# HOUSE NO. 2 - EXTERIOR EAST ELEVATION

SCALE: 1/4" = 1'-0"

## POLLY HILL SETTLEMENT

SAN SALVADOR, BAHAMAS, MARCH 2007

PREPARED BY: CARIBBEAN VOLUNTEER EXPEDITIONS (CVE)

VOLUNTEERS: FLORENCE BAKER, ROBERT GARBARK, BARBARA RICE,

SUSAN RICE, ROBERT TAYLOR

ALONG WITH DR. JOHN WINTER, JOHN COPICH, DON BERNIER AND MOLLOY  
COLLEGE STUDENTS - LEIF HAZLEWOOD AND JACI HEALY

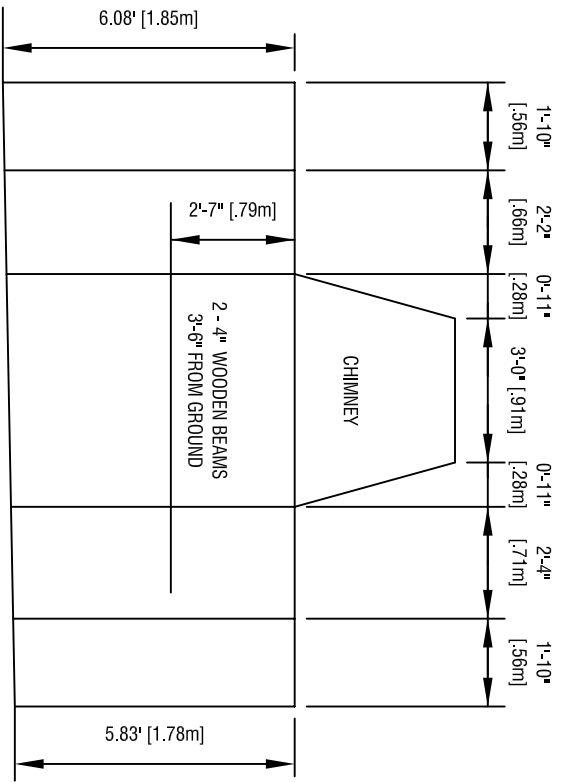

HOUSE NO. 5 - INTERIOR WEST ELEVATION

SCALE: 1/4" = 1'-0"

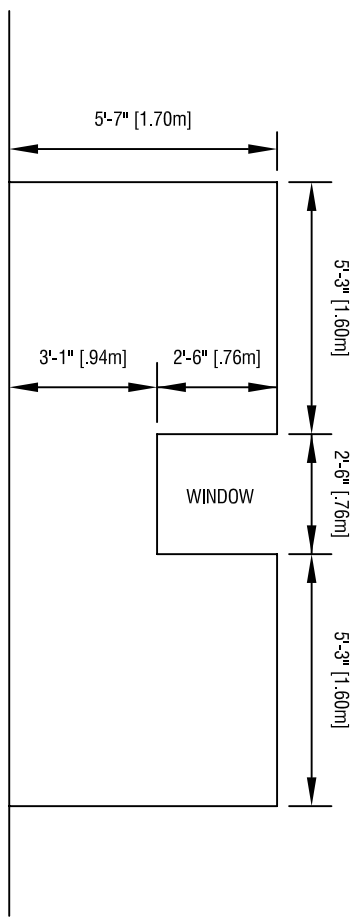

HOUSE NO. 5 - EAST ELEVATION

SCALE: 1/4" = 1'-0"

POLLY HILL SETTLEMENT

SAN SALVADOR, BAHAMAS, MARCH 2007

PREPARED BY: CARIBBEAN VOLUNTEER EXPEDITIONS (CVE)

VOLUNTEERS: FLORENCE BAKER, ROBERT GARBARK, BARBARA RICE, SUSAN RICE, ROBERT TAYLOR

ALONG WITH DR. JOHN WINTER, JOHN COPICH, DON BERNIER AND MOLLOY COLLEGE STUDENTS - LEIF HAZLEWOOD AND JACI HEALY

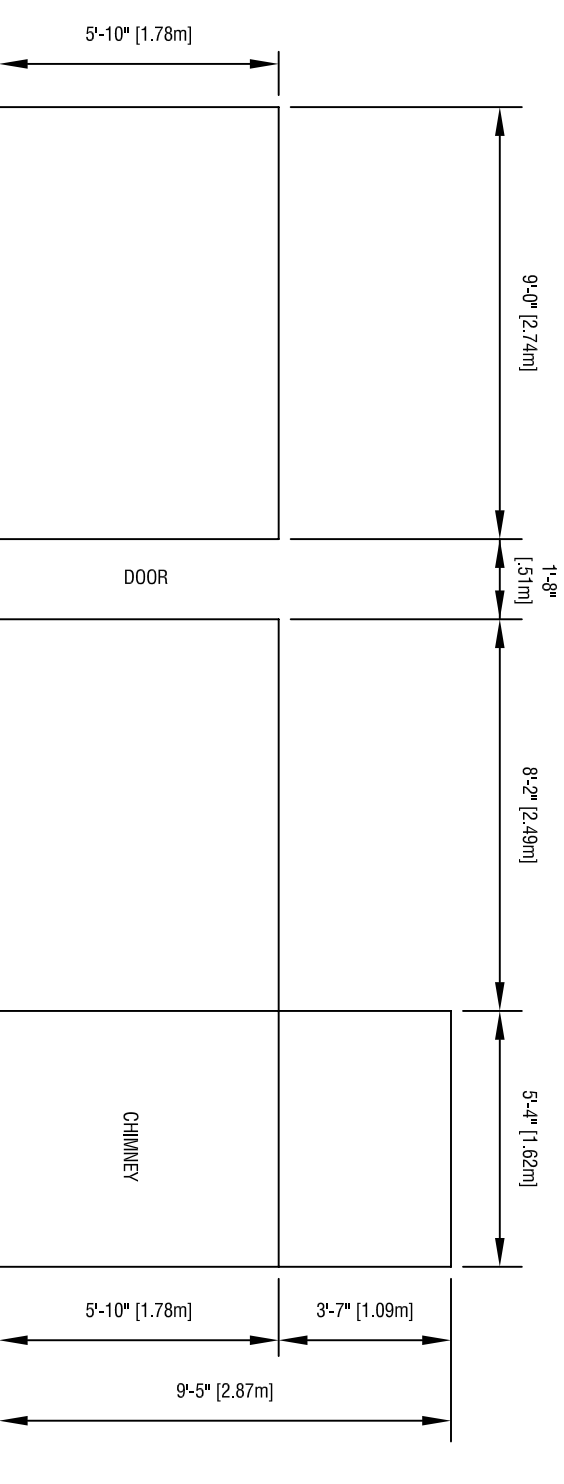

HOUSE NO. 5 - NORTH ELEVATION  
SCALE: 1/4" = 1'-0"

POLLY HILL SETTLEMENT  
SAN SALVADOR, BAHAMAS, MARCH 2007

PREPARED BY: CARIBBEAN VOLUNTEER EXPEDITIONS (C/VE)  
VOLUNTEERS: FLORENCE BAKER, ROBERT GARBARK, BARBARA RICE,  
SUSAN RICE, ROBERT TAYLOR

ALONG WITH DR. JOHN WINTER, JOHN COPICH, DON BERNIER AND MOLLOY  
COLLEGE STUDENTS - LEIF HAZLEWOOD AND JACI HEALY

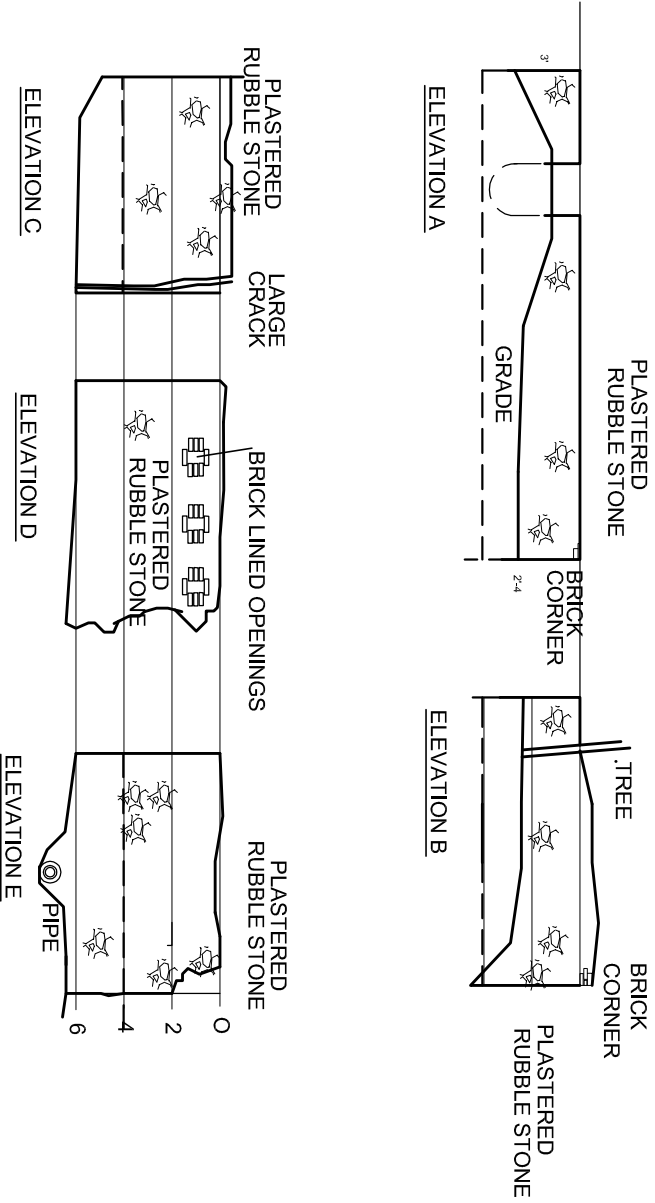
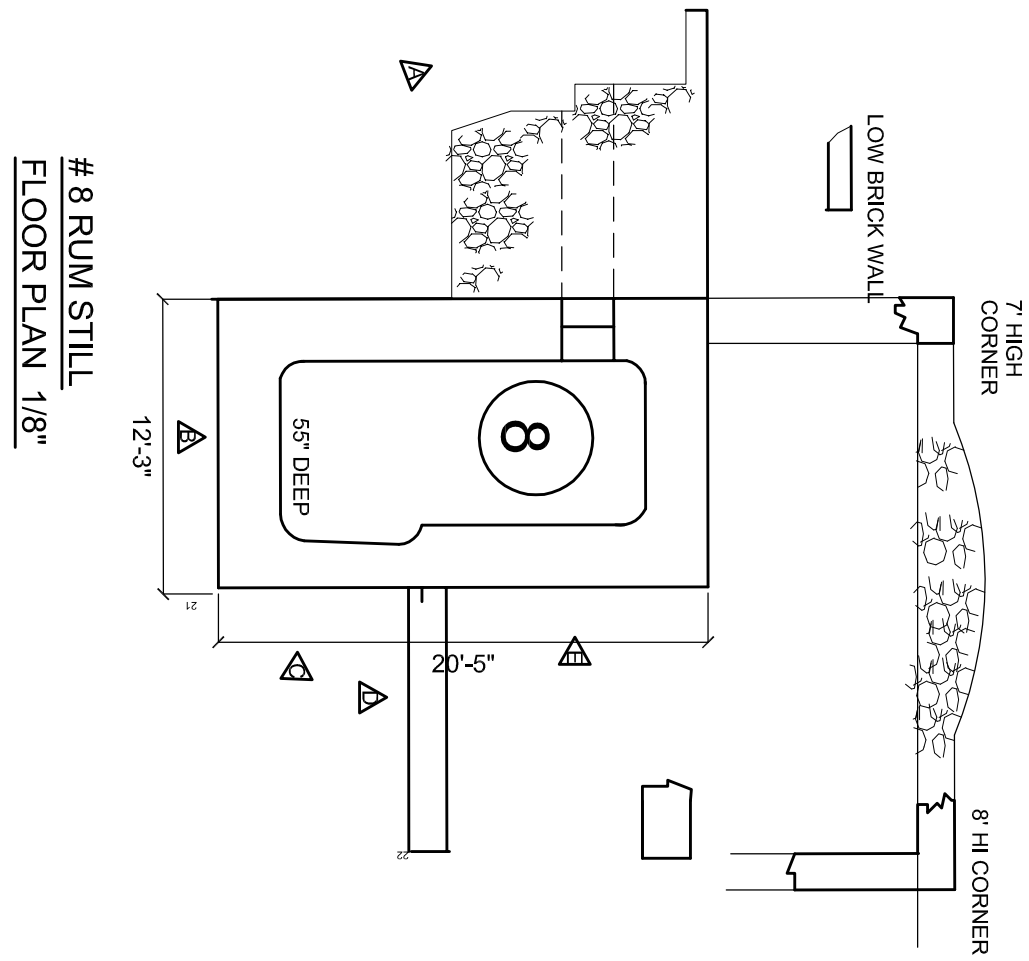
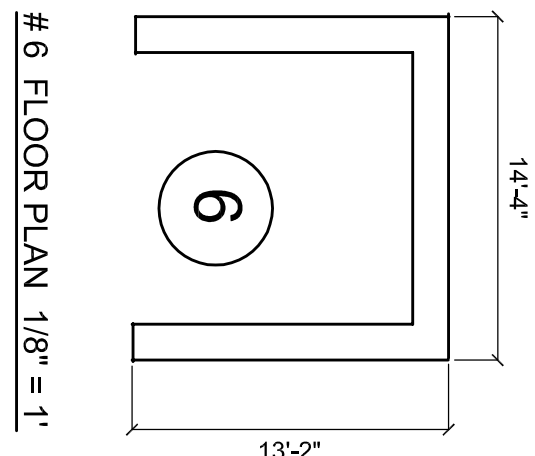
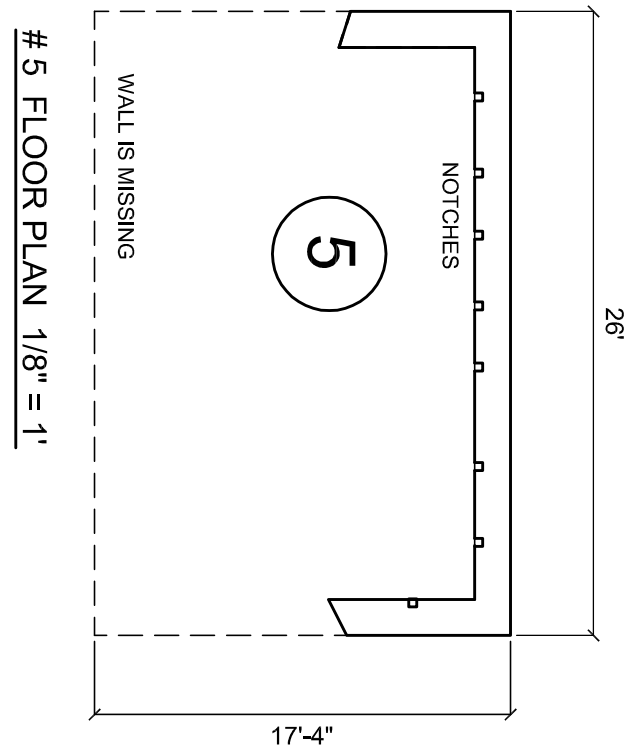
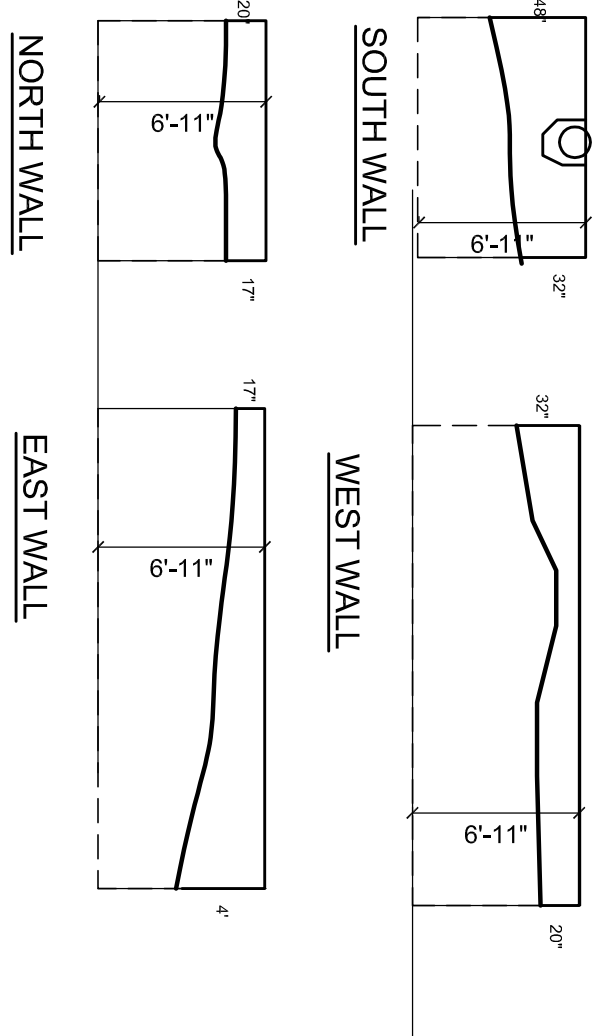
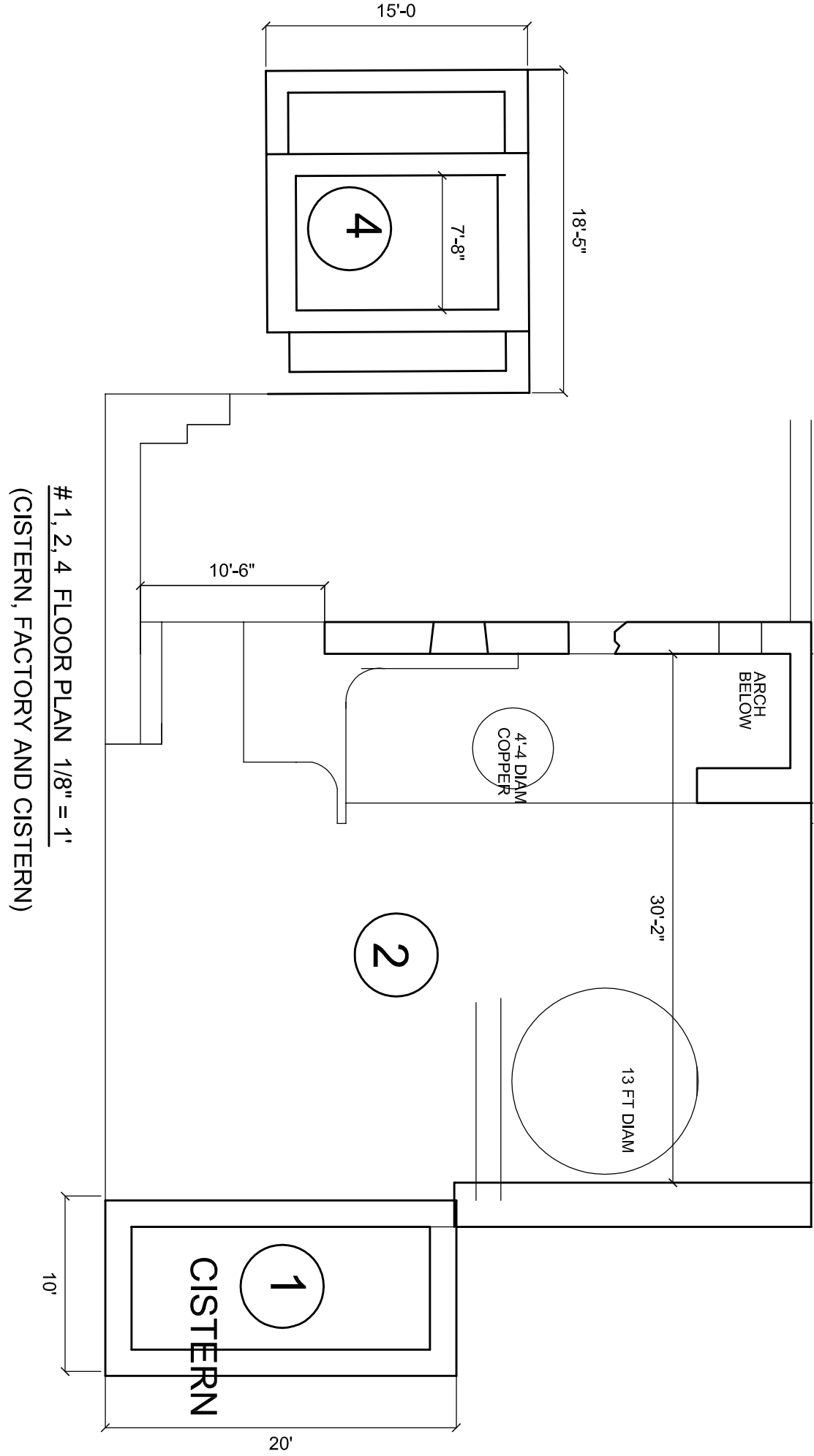

# 7 FLOOR PLAN 1/8" = 1"  
(POSSIBLE WAREHOUSE)

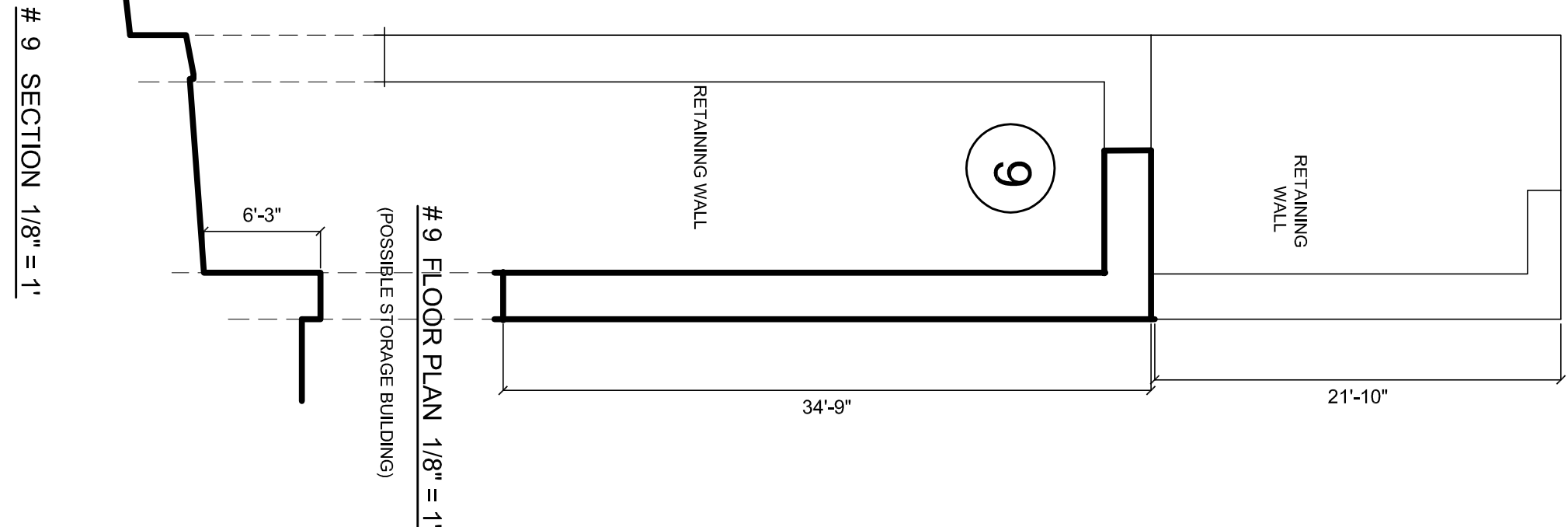
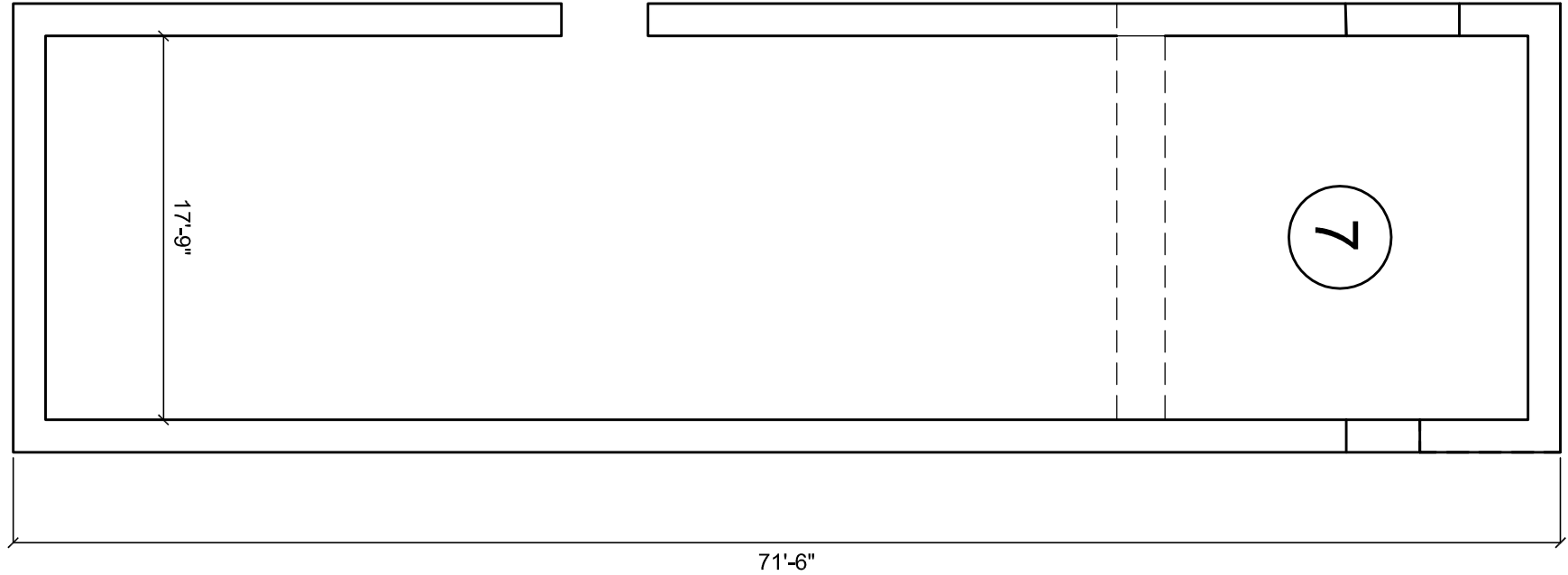

# RUSTENBERG ST JOHN, USVI

PREPARED BY CARIBBEAN VOLUNTEER EXPEDITIONS  
BOX 388 CORNING NY 14830 [www.cvexp.org](http://www.cvexp.org)  
2007 2008

FURTHER NORTH ARE  
PILLAR, RUBBLE WALLS,

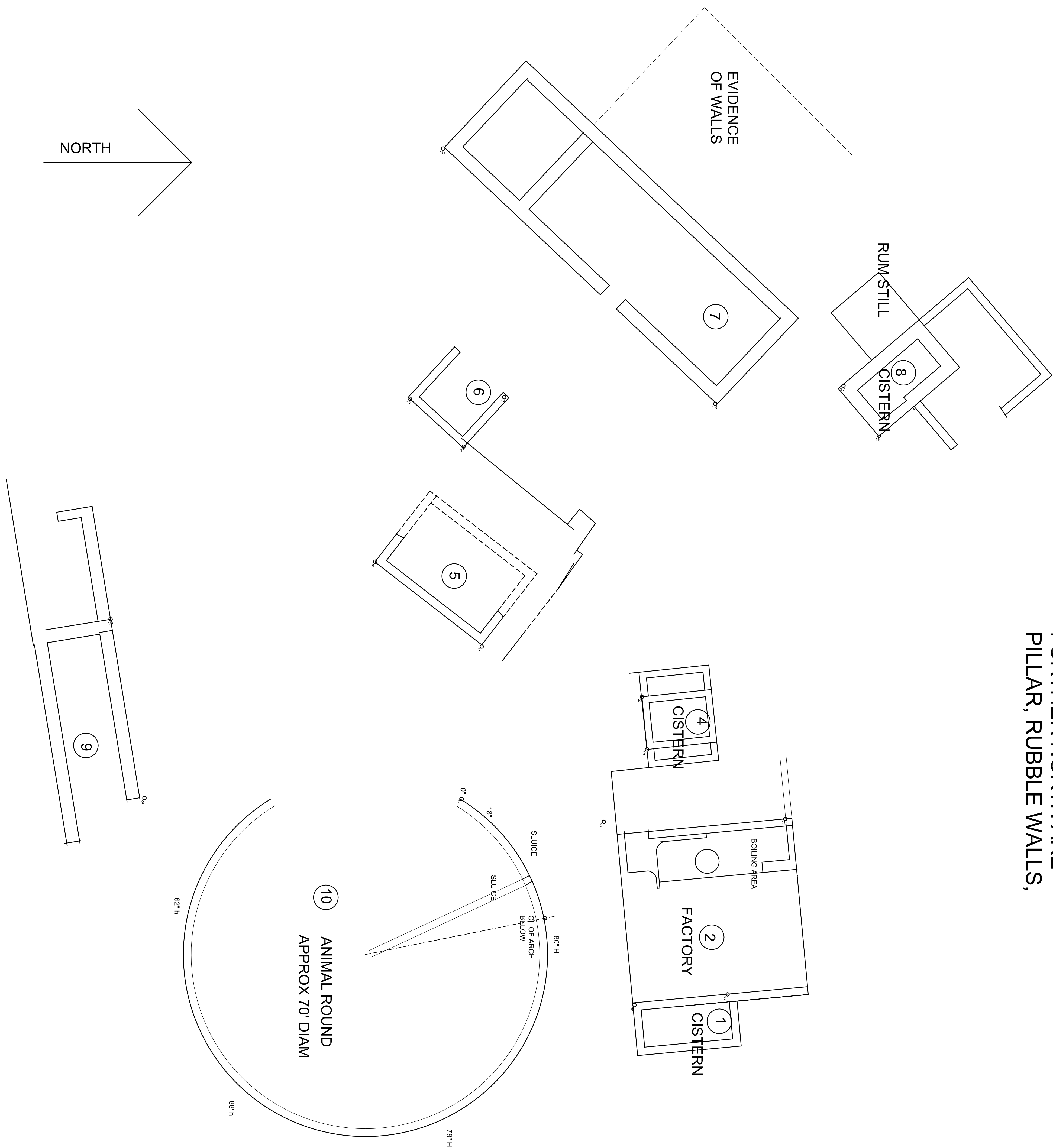

# SITE PLAN 1" = 10'

## RUSTENBERG ST JOHN, USVI

PREPARED BY CARIBBEAN VOLUNTEER EXPEDITIONS  
BOX 388 CORNING NY 14830 [www.cvexp.org](http://www.cvexp.org)  
2007 2008





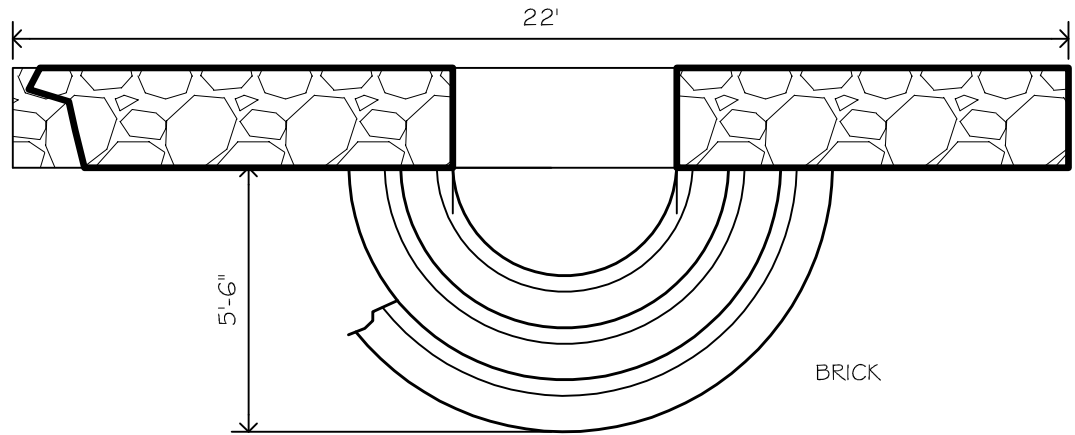

PLAN 1/4" = 1'



ELEVATION 1/4" = 1'

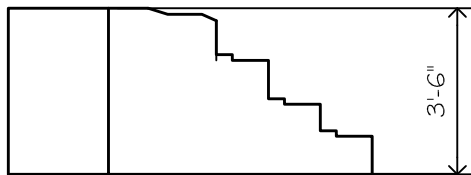

SECTION 1/4" = 1'

YAWSIE POINT STEPS  
BROWN BAY, ST. JOHN, USVI

MEASURED BY CARIBBEAN VOLUNTEER EXPEDITIONS  
BOX 388, CORNING, NY 14830

FOR THE US VIRGIN ISLAND NATIONAL PARK  
FEBRUARY 2005