

**BUILDING NO. 1**  
SCALE: 1/8" = 1'-0"

**NOTES AND OBSERVATIONS:**

1. BUILDING NO. 1 IS THOUGHT TO BE THE MAIN HOUSE.
2. ALL WALLS ARE PLASTERED. THE SOUTHEAST WALL IS COATED WITH TWO LAYERS OF PLASTER.
3. EVIDENCE OF 4" (.10m) DIAMETER WOODEN POST IN ALL MAIN CORNERS.
4. EVIDENCE OF PLASTER FLOOR IN MAIN AREA AND ON EAST SIDE OF MAIN AREA.
5. EVIDENCE OF LARGE WOODEN BEAM ON TOP OF NORTHEAST WALL (PLASTER HAS INDICATIONS OF WOODEN STRUCTURE.)
6. EVIDENCE OF WOOD FRAMING AND BEAMS IN WINDOWS. THREE APPROX. 3" (.08m) SQUARE BEAMS AT TOP OF WINDOW DOWELED INTO UPRIGHT WOODEN POST.
7. WALL FALLEN IN SITU NEAR DOOR IN SOUTHEAST WALL.
8. PIECE OF POTTERY FOUND WITHIN THE PLASTER IN SOUTHEAST WALL.

**HARD BARGAIN SURVEY**  
SAN SALVADOR, BAHAMAS, FEBRUARY 2004  
PREPARED BY: CARIBBEAN VOLUNTEER EXPEDITIONS (C/VE)  
VOLUNTEERS: S. RICE, A. AS CALLAWAN, R. GARBARK,  
R. HIRSCHMAN, J. MILLER, E. AM. ROBERTS, J. WILKINDE

NOTES AND OBSERVATIONS:

1. BUILDING NO. 2 IS THOUGHT TO BE THE COOK HOUSE.
2. WROUGHT IRON EYE BOLT FOUND UNDER WINDOW.
3. EVIDENCE OF PLASTER FLOOR IN SOUTH CORNER.
4. WALLS ARE PLASTERED.
5. EVIDENCE OF STONE HEARTH. EVIDENCE OF FIRE DUE TO SOOTY SOIL AND ASH.
6. EVIDENCE OF BADLY BURNT FLOOR NEAR HEARTH.
7. GLASS & BOTTLE NECKS FOUND IN VICINITY OF HEARTH.

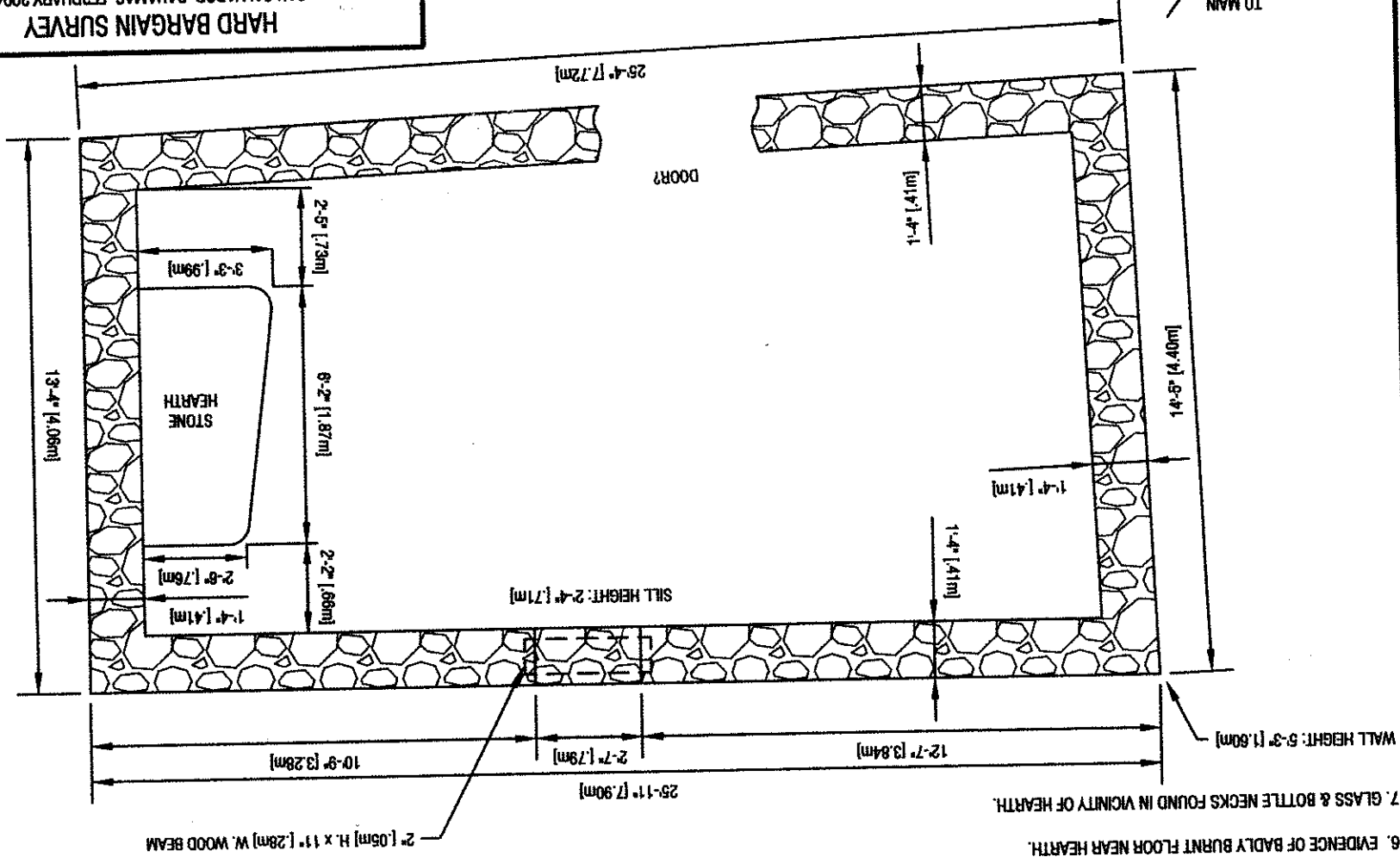
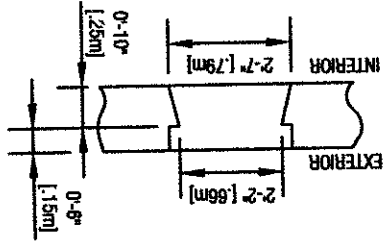

HARD BARGAIN SURVEY  
 SAN SALVADOR, BAHAMAS, FEBRUARY 2004  
 PREPARED BY: CARIBBEAN VOLUNTEER EXPEDITIONS (CVE)  
 VOLUNTEERS: S. RICE, A.S. CALLAHAN, R. GARBARK,  
 R. HIBSCHMAN, J. MILLER, E. & M. ROBERTS, J. WILHIDE

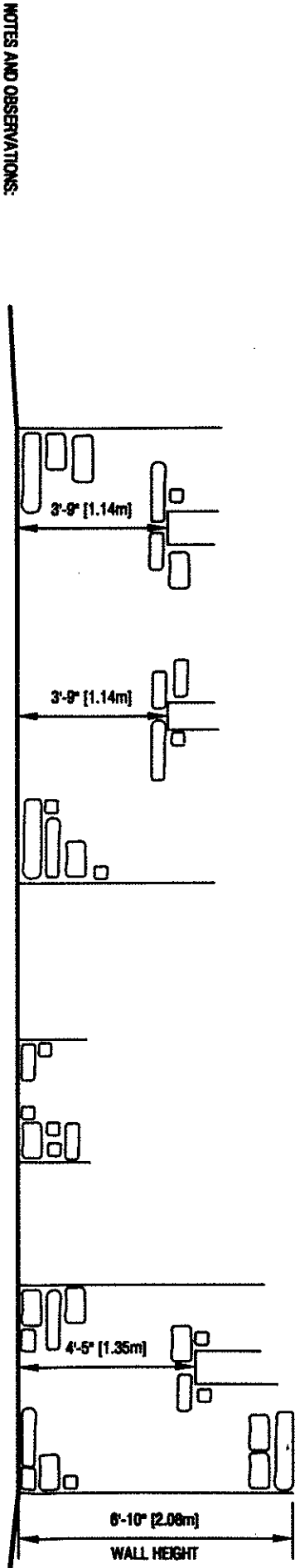
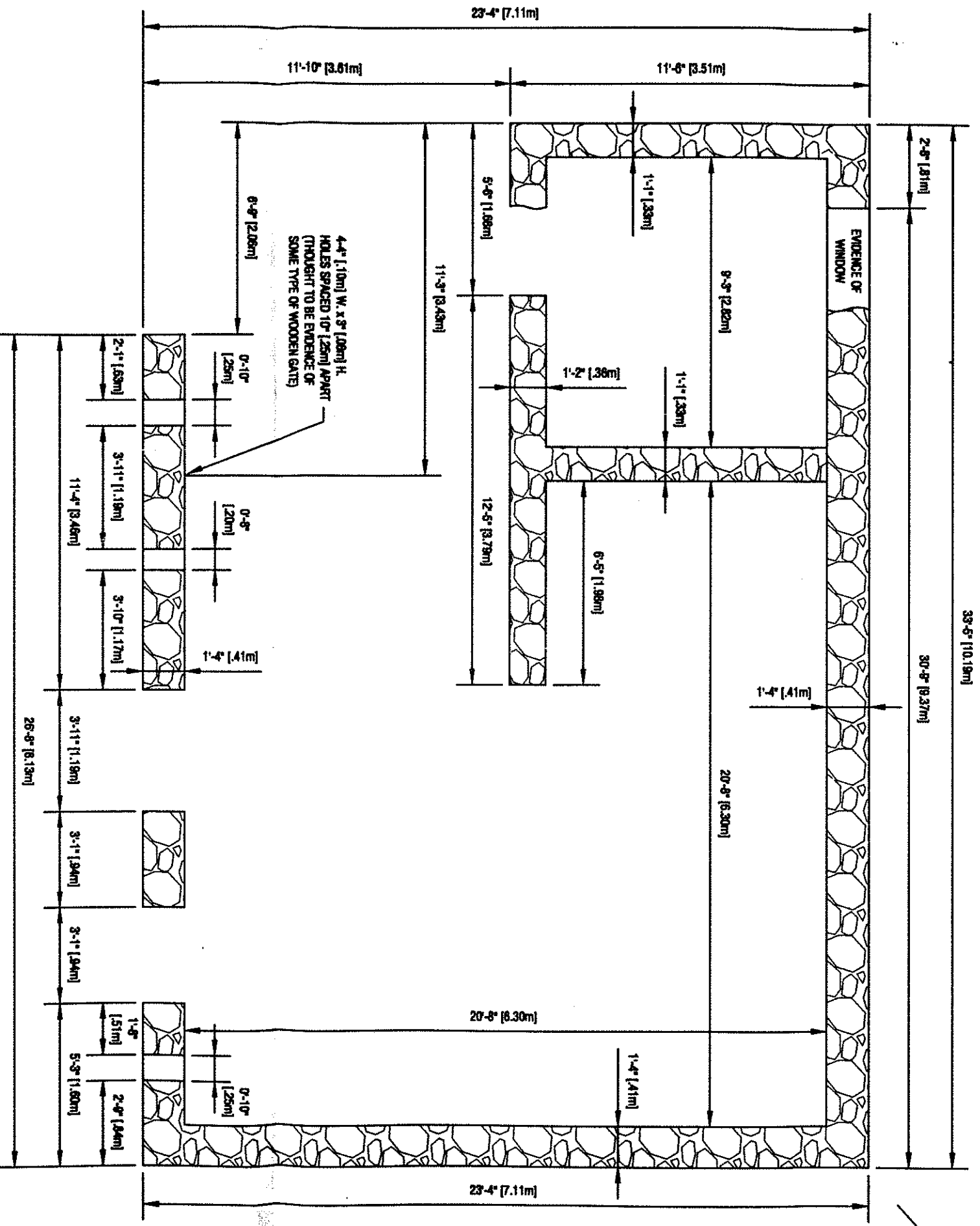

NOTES AND OBSERVATIONS:

1. BUILDING NO. 4 IS THOUGHT TO BE THE STABLES.
2. SOUTHWEST WALL FALLEN IN SITU IS EVIDENCE THAT THE ENTIRE STRUCTURE WAS BUILT TO THE SAME HEIGHT AS THE NORTHEAST CORNER - APPROX. 6'-10" [2.08m].
3. EVIDENCE OF VENTILATION IN THE SOUTHEAST WALL - 3 OPENINGS NOT LARGE ENOUGH FOR A TYPICAL WINDOW.
4. EVIDENCE OF WOODEN DOOR FRAMES IN THE SOUTHEAST WALL.
5. EVIDENCE OF HOLES IN THE INTERIOR OF THE SOUTHEAST WALL THAT MAY HAVE BEEN USED TO SUPPORT WOOD BEAMS IN ORDER TO FORM A GATE.
6. EVIDENCE OF WOOD FRAME FOR A POSSIBLE DOOR OR WINDOW IN WEST CORNER.
7. EVIDENCE OF A PLASTER FLOOR WAS FOUND IN THE SOUTHWEST CORNER OF THE STRUCTURE.



BUILDING NO. 4  
SCALE: 1/4" = 1'-0"

HARD BARGAIN SURVEY  
SAN SALVADOR, BAHAMAS, FEBRUARY 2004  
PREPARED BY: CARIBBEAN VOLUNTEER EXPEDITIONS (CVE)  
VOLUNTEERS: S. RICE, A. & S. CALLAHAN, R. GARBARAK,  
R. HIRSCHMAN, J. MILLER, E. MALROBERTS, J. WILHIDE

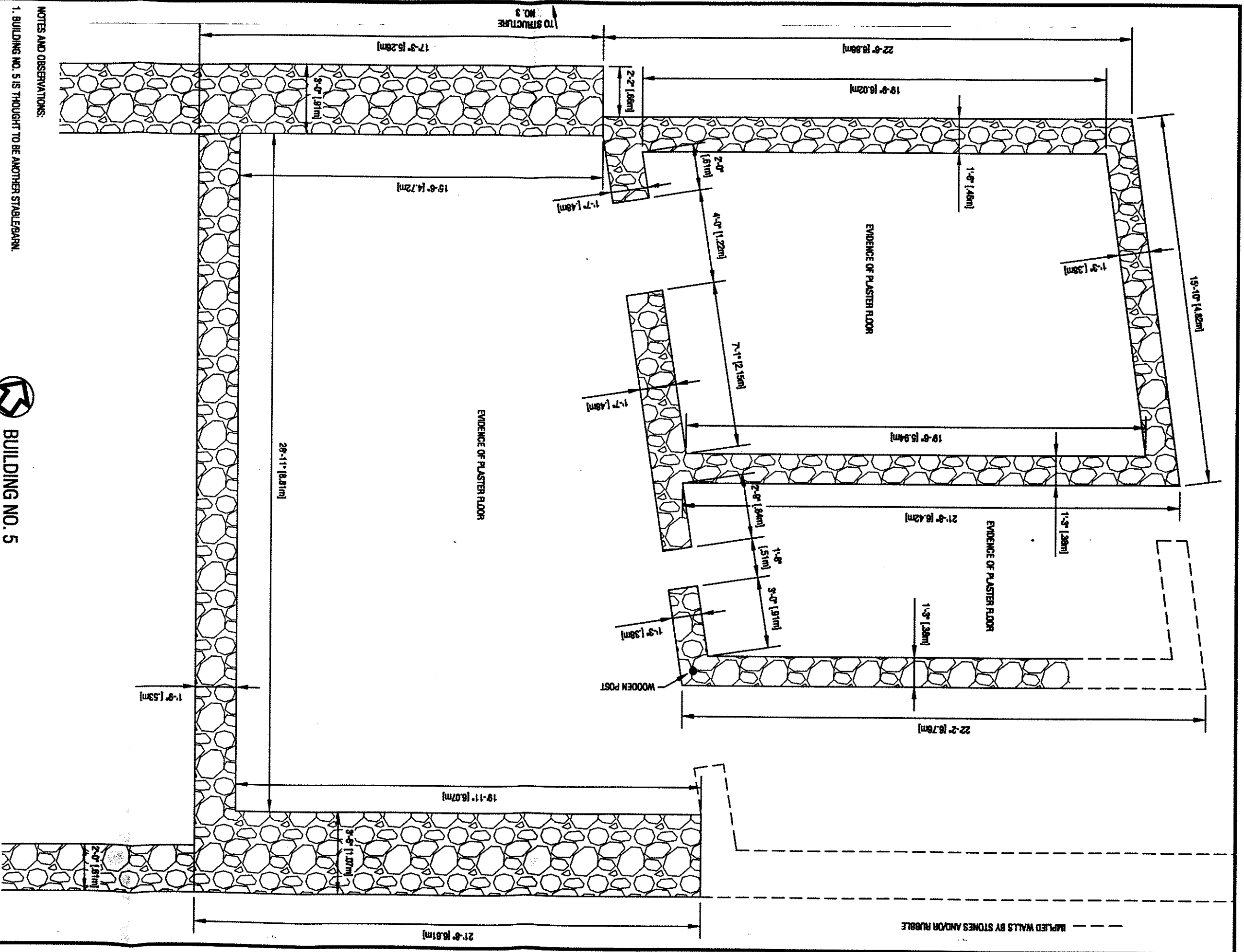

NOTES AND OBSERVATIONS:

1. BUILDING NO. 5 IS THOUGHT TO BE ANOTHER STABLE/BARN
2. SOUTHWEST WALL: WALL IS PLASTERED WITH TWO DIFFERENT TYPES OF PLASTER, ONE FROM FLOOR TO HALFWAY UP THE WALL, THE OTHER FROM HALFWAY UP THE WALL TO THE TOP.
3. EVIDENCE OF DOOR SILLS AND DOOR FRAMES (SQUARE EDGES IN PLASTER) IN DIAGONAL WALL.
4. EVIDENCE OF PLASTER FLOOR IN SOME PARTITIONED ROOMS.
5. 4" (1.0m) DIAMETER WOODEN POST IN CORNER OF WALL.
6. THE LARGE WALLED AREA IS AT HIGHER ELEVATION THAN THE REMAINING AREAS. MUST STEP DOWN.
7. ALL FLOORS APPEAR TO BE AT DIFFERENT LEVELS.



**BUILDING NO. 5**  
SCALE: 1/4" = 1'-0"

**HARD BARGAIN SURVEY**  
SAN SALVADOR, BAHAMAS, FEBRUARY 2004

PREPARED BY: CARIBBEAN VOLUNTEER EXPEDITIONS (CVE)  
VOLUNTEERS: S. RICE, A.S. CALLAWAY, R. GARBARAK  
R. HIRSCHMAN, J. MILLER, E.A.M. ROBERTS, J. WILHDE

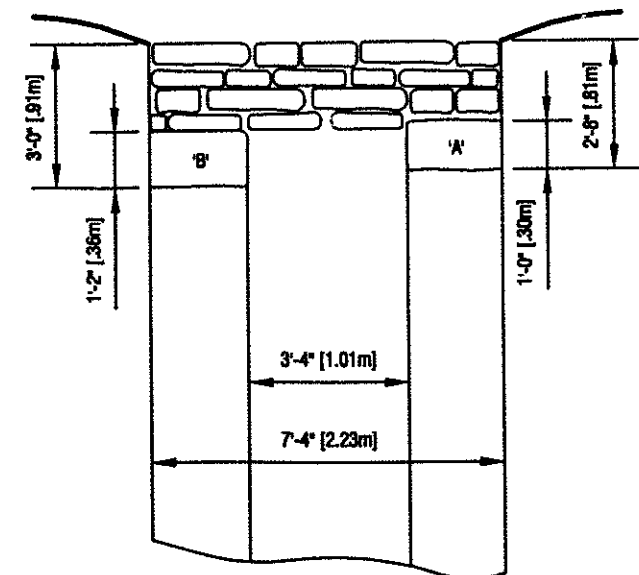
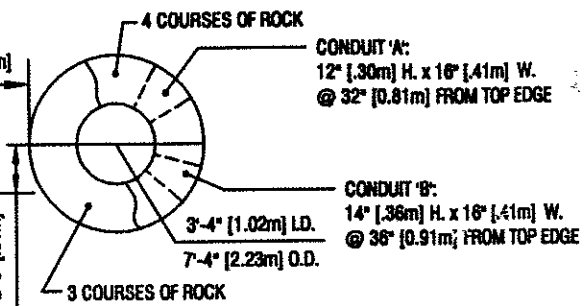
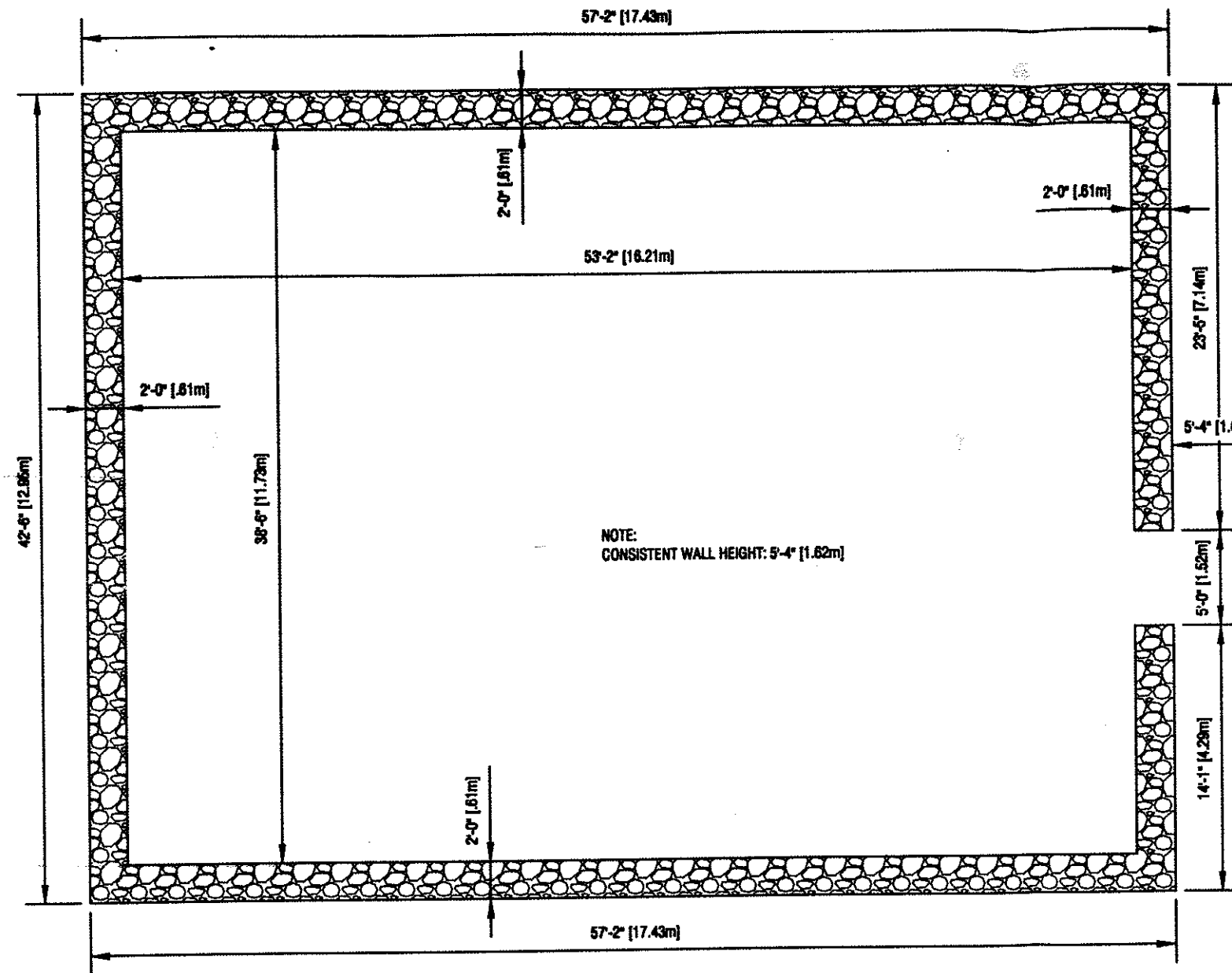

NOTE:  
WELL DEPTH UNKNOWN

WELL ELEVATION  
SCALE: 1/4" = 1'-0"



PEN & WELL  
SCALE: 1/8" = 1'-0"

HARD BARGAIN SURVEY  
SAN SALVADOR, BAHAMAS, FEBRUARY 2004  
PREPARED BY: CARIBBEAN VOLUNTEER EXPEDITIONS (CVE)  
VOLUNTEERS: S.RICE, A.&S.CALLAHAN, R.GARBARK,  
R.HIBSCHMAN, J.MILLER, E.&M.ROBERTS, J.WILHIDE

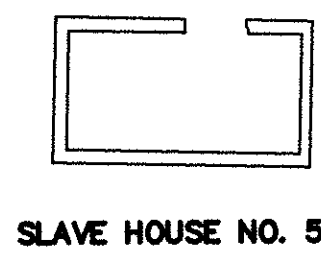
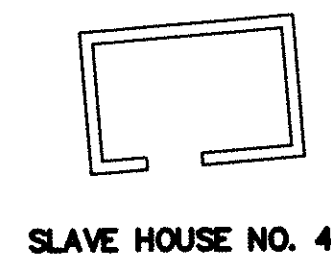
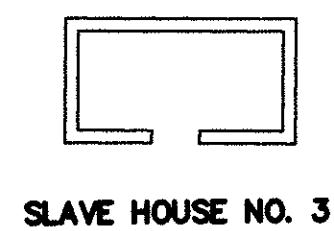
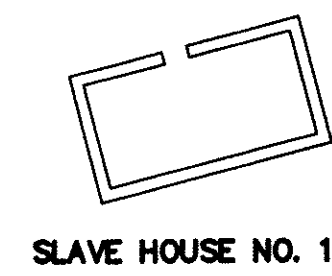
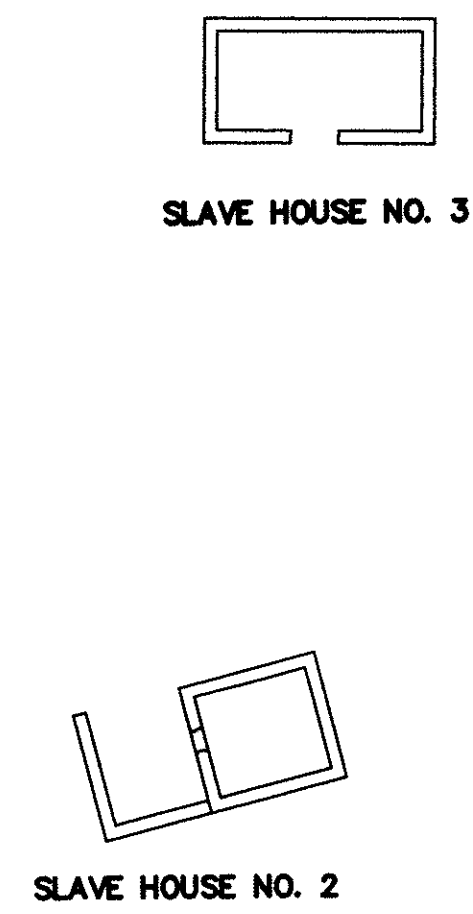

SLAVE HOUSES & VICINITY  
SCALE: 1"=20'

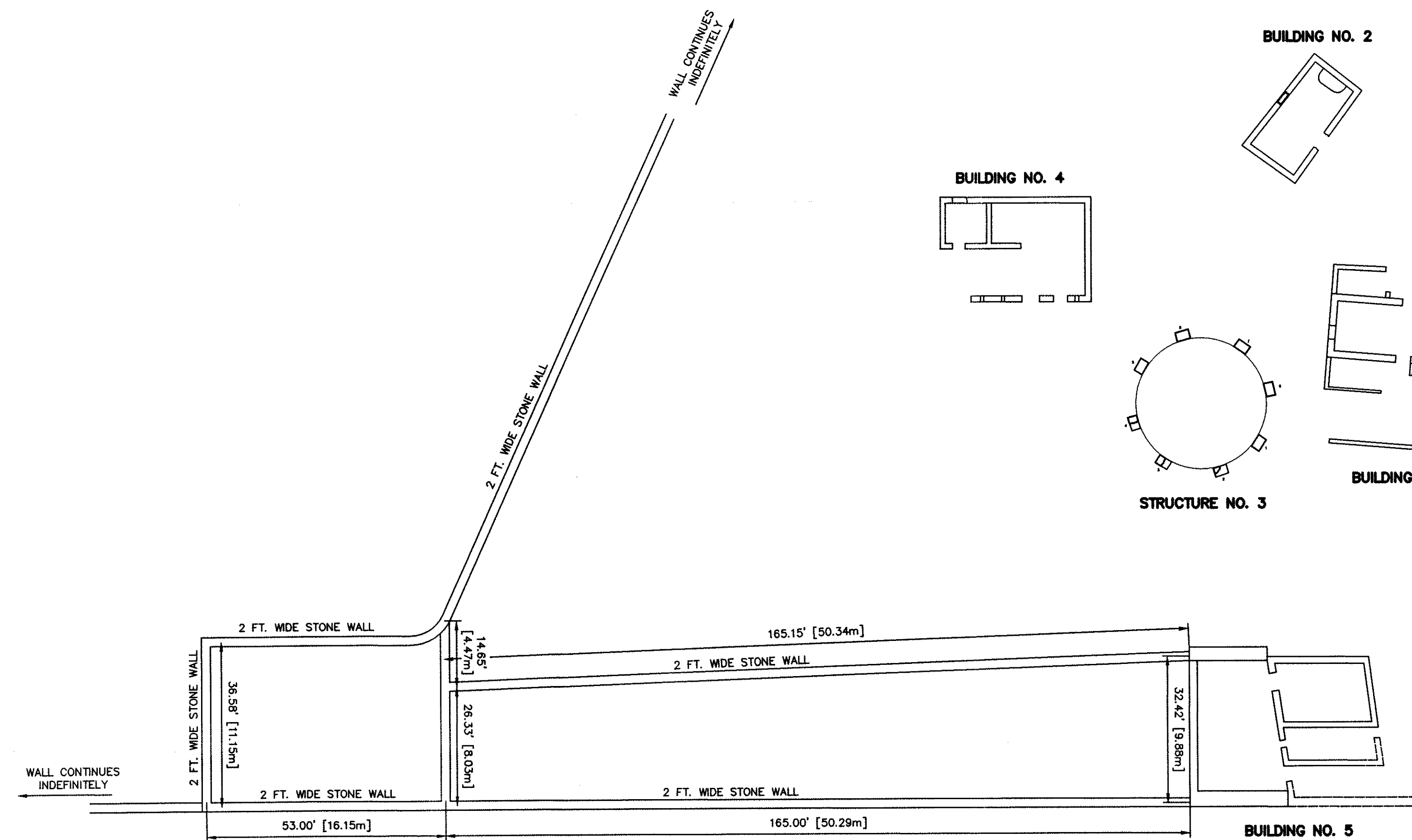
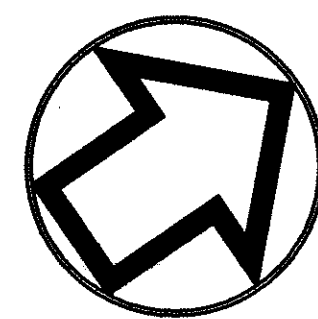

MAIN HOUSE & VICINITY  
SCALE: 1"=20'

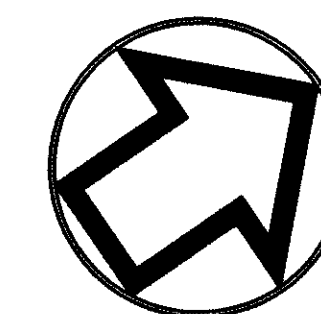

**HARD BARGAIN SURVEY**  
 SAN SALVADOR, BAHAMAS, FEBRUARY 2004  
 PREPARED BY: CARIBBEAN VOLUNTEER EXPEDITIONS (CVE)  
 VOLUNTEERS: S.RICE, A.&S.CALLAHAN, R.GARBARK,  
 R.HIBSCHMAN, J.MILLER, E.&M.ROBERTS, J.WILHIDE

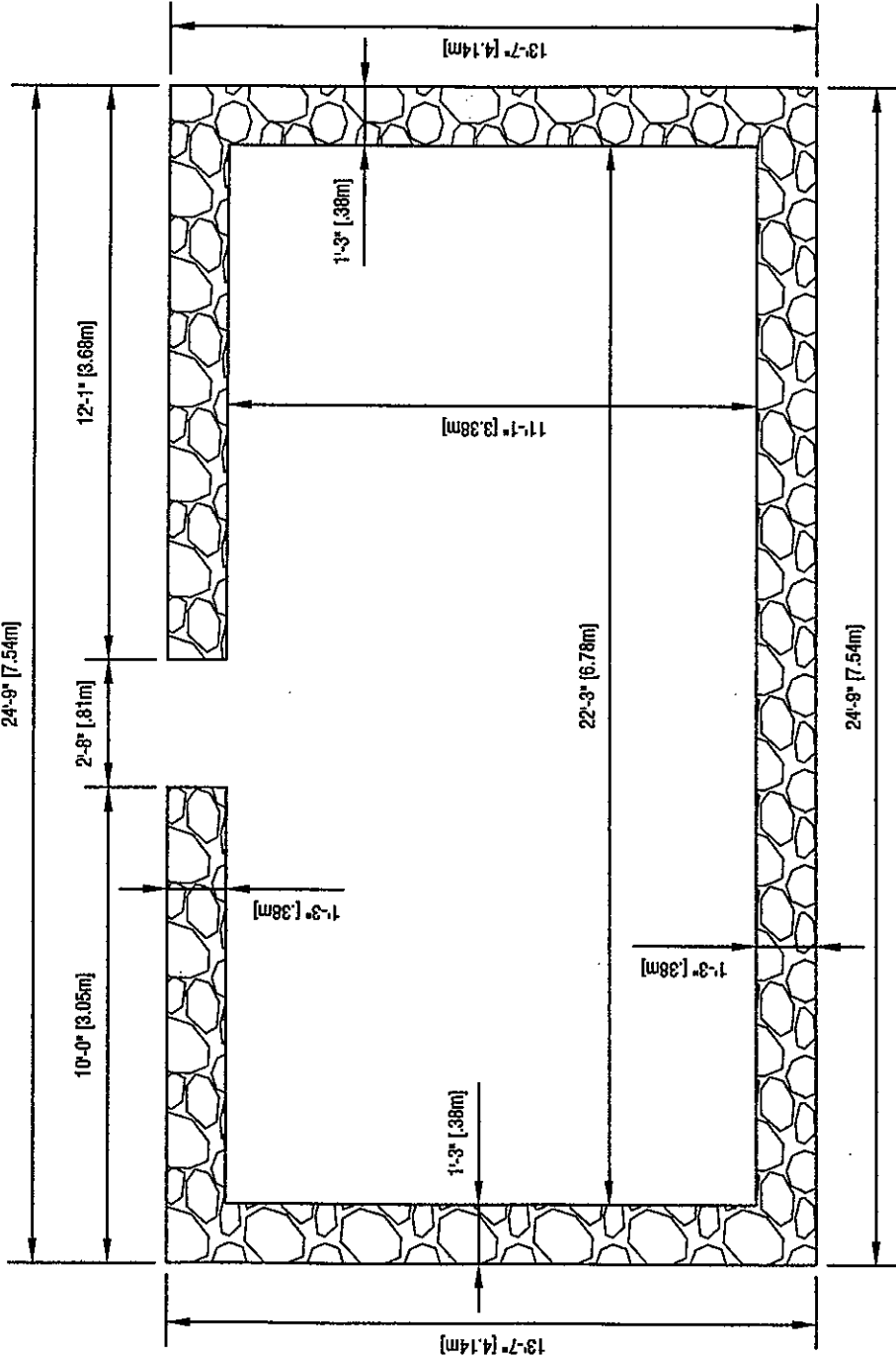

SLAVE HOUSE NO. 1

SCALE: 1/4" = 1'-0"



**HARD BARGAIN SURVEY**  
 SAN SALVADOR, BAHAMAS, FEBRUARY 2004

PREPARED BY: CARIBBEAN VOLUNTEER EXPEDITIONS (C/VE)  
 VOLUNTEERS: S. RICE, A. & S. CALLAHAN, R. GARBARK,  
 R. HIBSCHMAN, J. MILLER, E. & M. ROBERTS, J. WILHIDE

TO SLAVE  
NO. 3

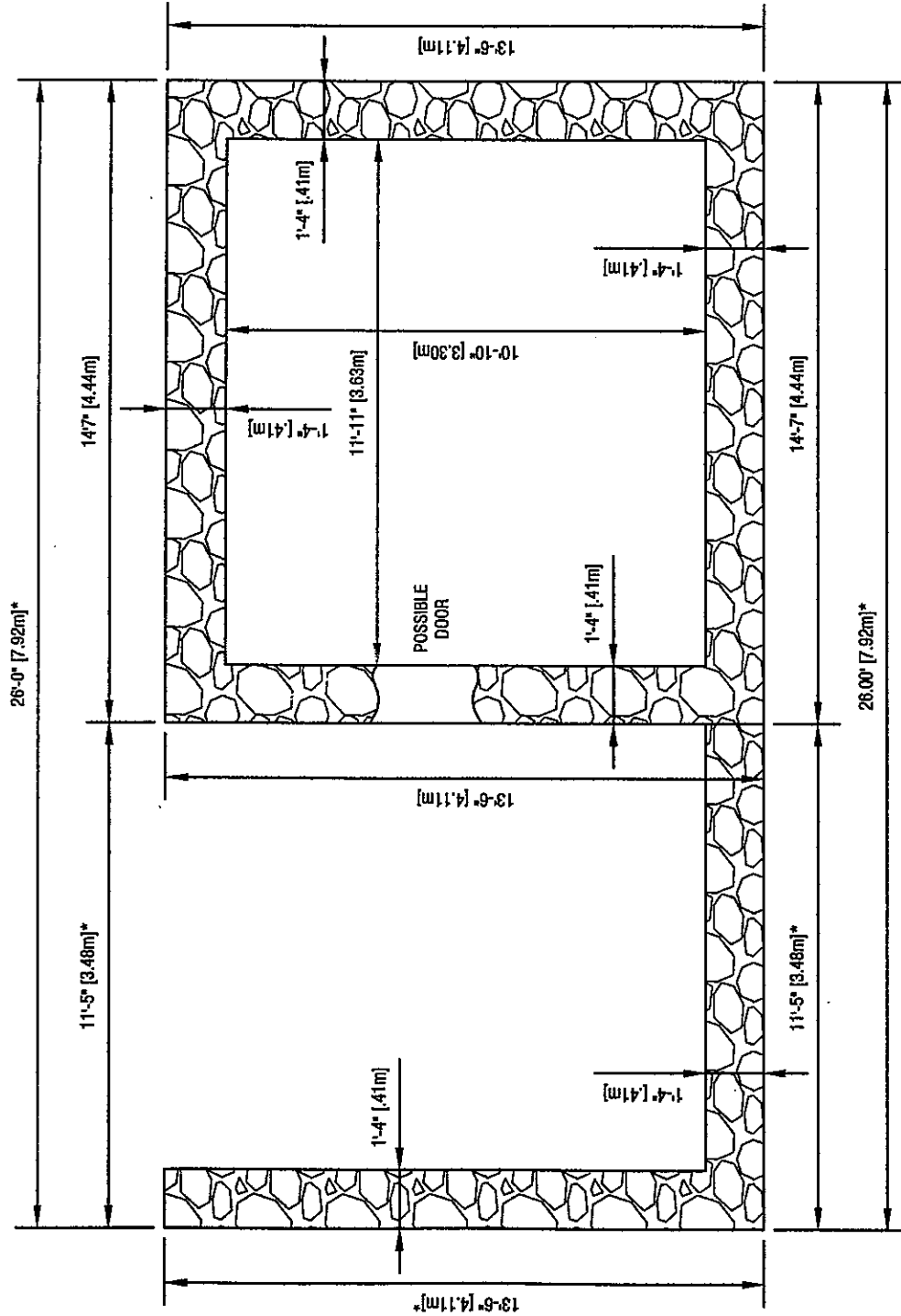

TO SLAVE  
NO. 1

\* APPROXIMATE DIMENSIONS. WALL IS EVIDENT BUT NOT WELL DEFINED.



**SLAVE HOUSE NO. 2**  
SCALE: 1/4" = 1'-0"

**HARD BARGAIN SURVEY**  
SAN SALVADOR, BAHAMAS, FEBRUARY 2004  
**PREPARED BY: CARIBBEAN VOLUNTEER EXPEDITIONS (CVE)**  
VOLUNTEERS: S. RICE, A. & S. CALLAHAN, R. GARBARK,  
R. HIBSCHMAN, J. MILLER, E. & M. ROBERTS, J. WILHIDE



NOTE: RANDOM ROCKS FORMING A DISTINGUISHABLE SEMI-CIRCLE EXTENDS APPROXIMATELY 23 FEET TO THE NORTHWEST

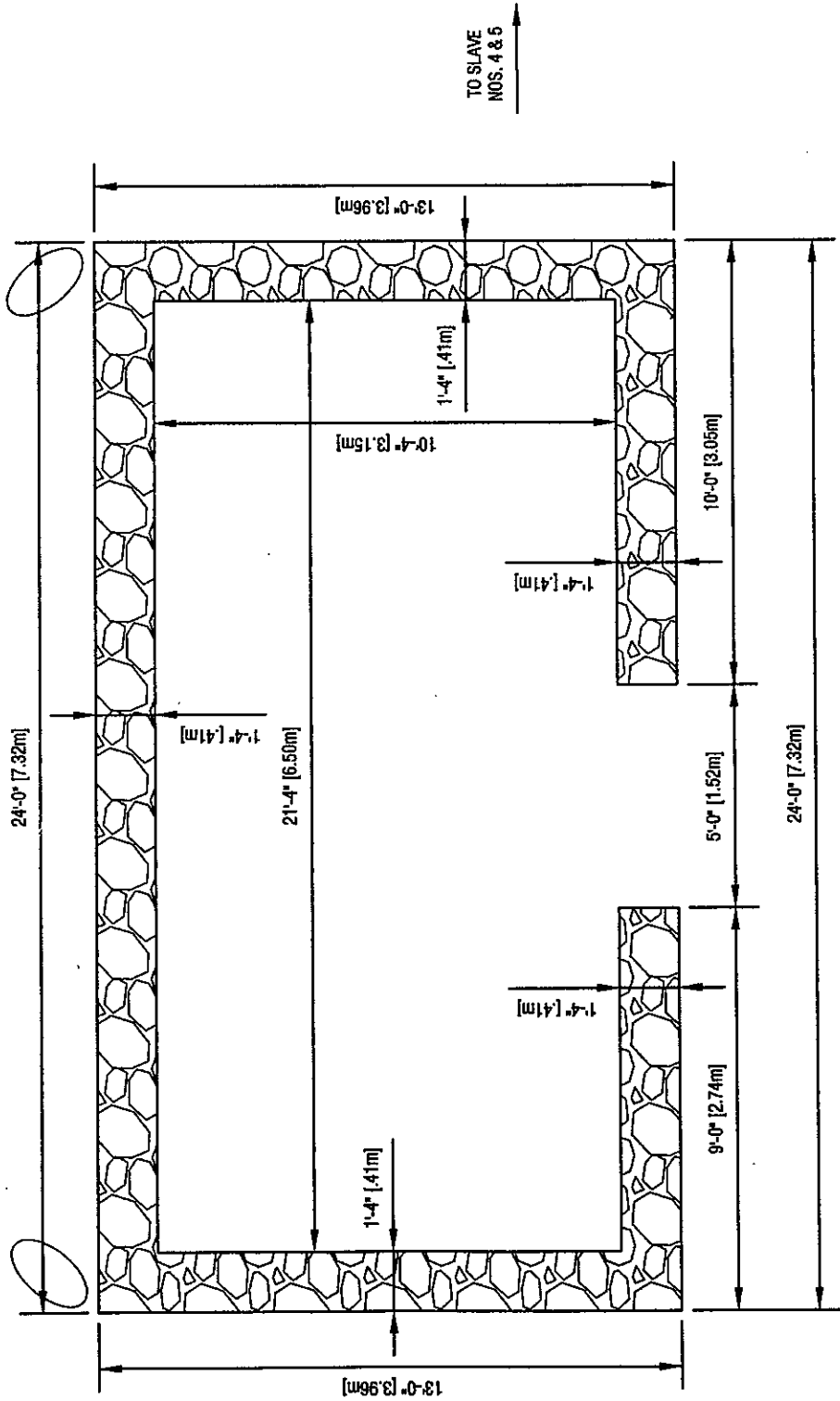

**SLAVE HOUSE NO. 3**  
SCALE: 1/4" = 1'-0"



TO SLAVE  
NO. 2

**HARD BARGAIN SURVEY**  
SAN SALVADOR, BAHAMAS, FEBRUARY 2004  
PREPARED BY: CARIBBEAN VOLUNTEER EXPEDITIONS (CVE)  
VOLUNTEERS: S. RICE, A. & S. CALLAHAN, R. GARBARK,  
R. HIRSCHMAN, J. MILLER, E. & M. ROBERTS, J. WILHIDE

TO SLAVE  
NO. 5

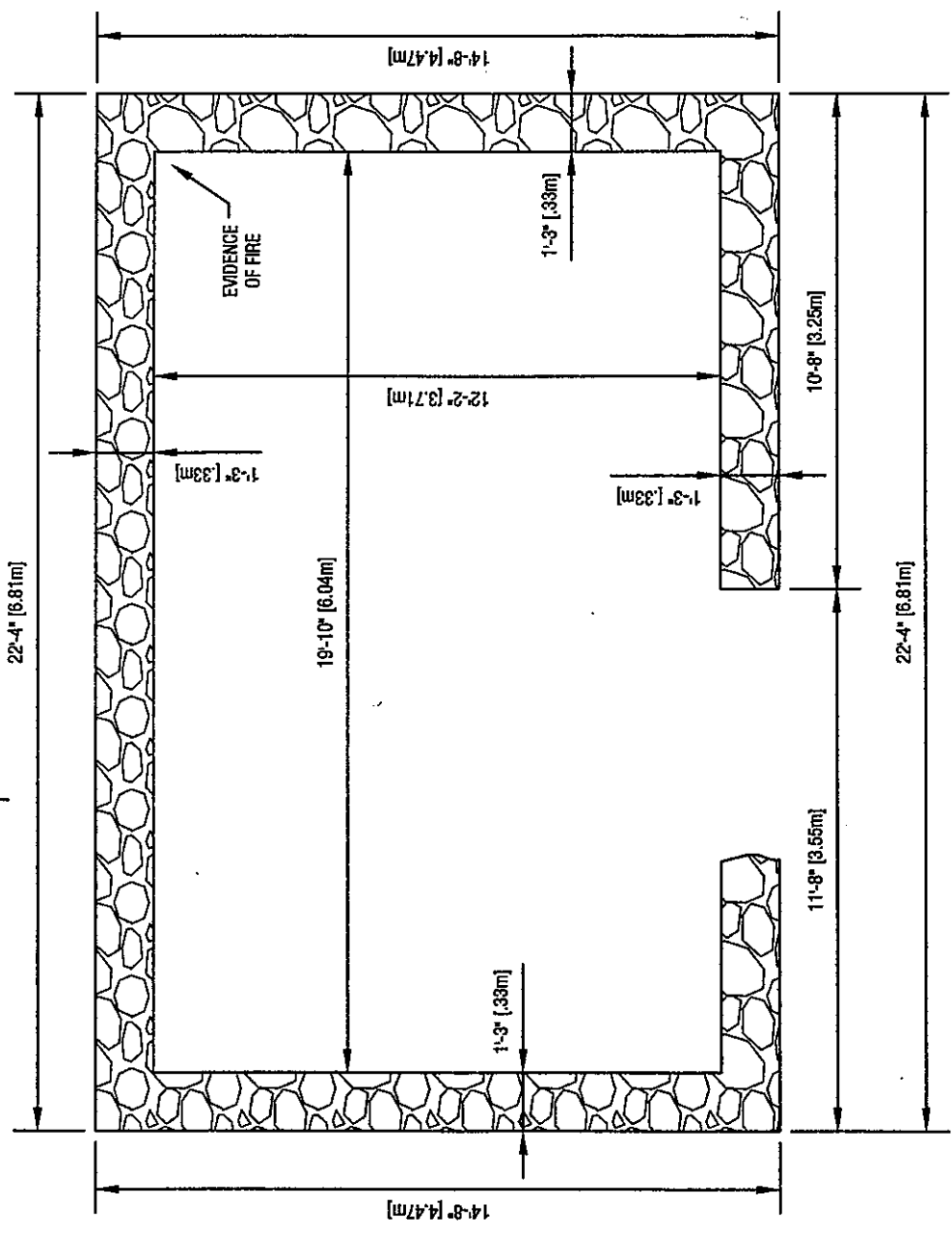

TO SLAVE  
NOS. 2 & 3

### SLAVE HOUSE NO. 4

SCALE: 1/4" = 1'-0"



TO SLAVE  
NO. 1

**HARD BARGAIN SURVEY**  
 SAN SALVADOR, BAHAMAS, FEBRUARY 2004

**PREPARED BY: CARIBBEAN VOLUNTEER EXPEDITIONS (CVE)**  
 VOLUNTEERS: S. RICE, A. & S. CALLAHAN, R. GARBARK,  
 R. HIBSCHMAN, J. MILLER, E. & M. ROBERTS, J. WILHIDE

NOTE: RANDOM ROCKS FORMING A DISTINGUISHABLE SEMI-CIRCLE EXTENDING TO THE NORTHWEST

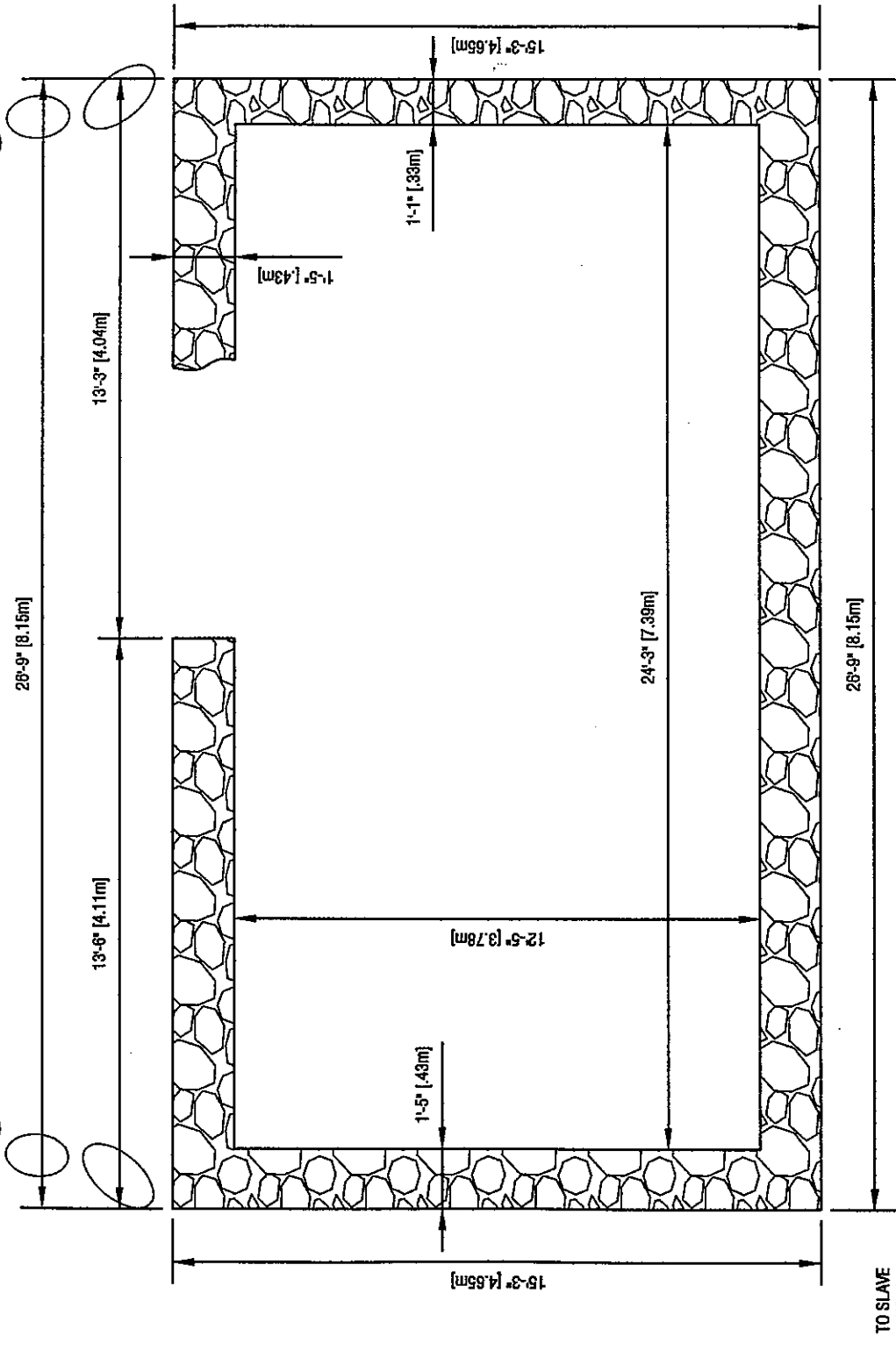

**SLAVE HOUSE NO. 5**

SCALE: 1/4" = 1'-0"

TO SLAVE NO. 4

**HARD BARGAIN SURVEY**  
 SAN SALVADOR, BAHAMAS, FEBRUARY 2004

PREPARED BY: CARIBBEAN VOLUNTEER EXPEDITIONS (CVE)  
 VOLUNTEERS: S. RICE, A. & S. CALLAHAN, R. GARBARK,  
 R. HIBSCHMAN, J. MILLER, E. & M. ROBERTS, J. WILHIDE

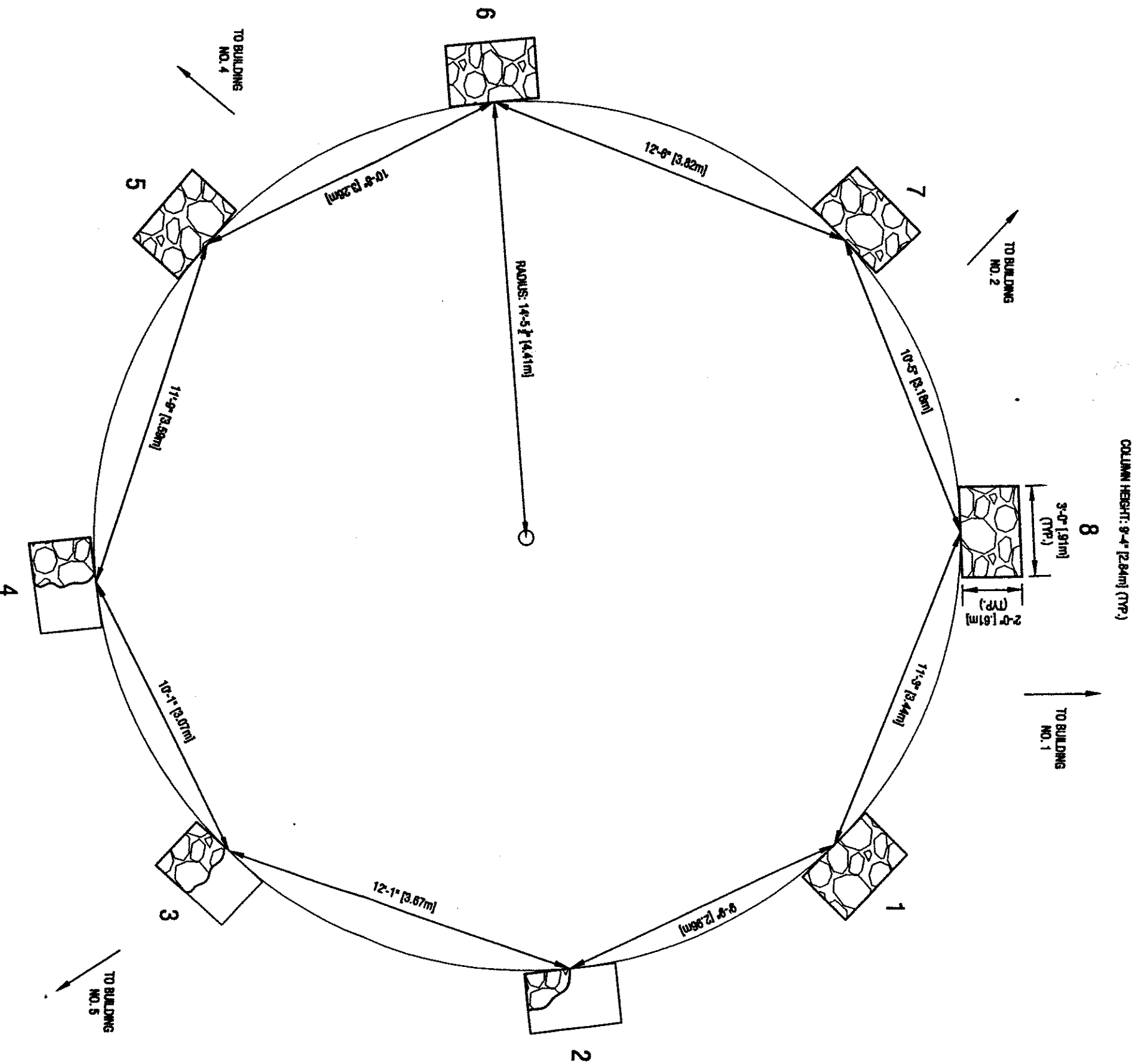

STRUCTURE NO. 3  
SCALE: 1/4" = 1'-0"

NOTES AND OBSERVATIONS:

1. STRUCTURE NO. 3 IS THOUGHT TO BE THE GAMING CIRCLE.
2. COLUMNS WERE PLASTERED.
3. EVIDENCE THAT COLUMNS WERE PAINTED RED/PINK.
4. EVIDENCE OF APPROXIMATELY 4" [1.0m] SQUARE WOODEN POST INSIDE EACH COLUMN.
5. TOP OF COLUMNS HAD CURVED DETAIL. (SEE DETAIL RIGHT.)
6. NUMEROUS COLUMNS HAD HOLES IN VARIOUS LOCATIONS. ALL WERE APPROXIMATELY THE SAME SIZE: 2.5" [0.6m] SQUARE.
7. COLUMNS 1 THROUGH 5 AND 8 HAD VISIBLE HOLES AS DESCRIBED ABOVE:
  - a. COLUMN 1: HOLE THROUGH ENTIRE COLUMN
  - b. COLUMN 4: HOLE FROM OUTSIDE TO MIDDLE OF COLUMN
  - c. COLUMN 5: HOLE FROM INSIDE TO MIDDLE OF COLUMN
  - d. COLUMN 8: HOLE FROM INSIDE TO MIDDLE OF COLUMN
 HOLES ARE THOUGHT TO BE USED FOR SUPPORT STRUCTURES.
8. COLUMNS 2, 3 AND 4 ARE PARTIALLY IN PLACE AS INDICATED.

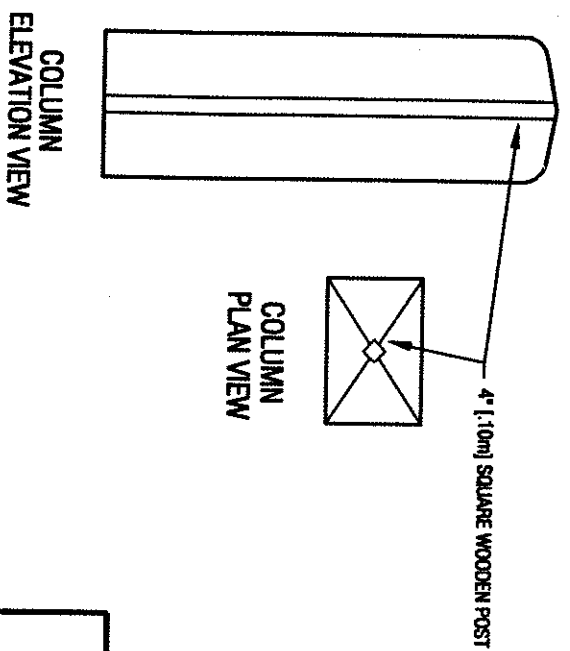

HARD BARGAIN SURVEY  
SAN SALVADOR, BAHAMAS, FEBRUARY 2004  
PREPARED BY: CARIBBEAN VOLUNTEER EXPEDITIONS (CVE)  
VOLUNTEERS: S. RICE, A.S. CALLAHAN, R. GARBARAK,  
R. HIRSCHMAN, J. MILLER, E. AM. ROBERTS, J. WILHIDE